

NINGBO LONGMA VEHICLE INDUSTRY CO.,LTD.

Add:#25-29 Kandun east Road, Cixi Avenue, Cixi City,  
Ningbo, China.

Tel:0086-574-23670081 23670083

Fax:0086-0574-63288372

Http://www.loma-cardle.com

E-mail:sales@loma-cardle.com

P.C:315303

# INSTRUCTION FOR USE

Congratulations on your purchase of the child seat. Please read this instruction manual carefully before use. If you have any questions concerning the use of this child seat, please do not hesitate to contact us.

## CHILD RESTRAINT LM228 WITH ISOFIX

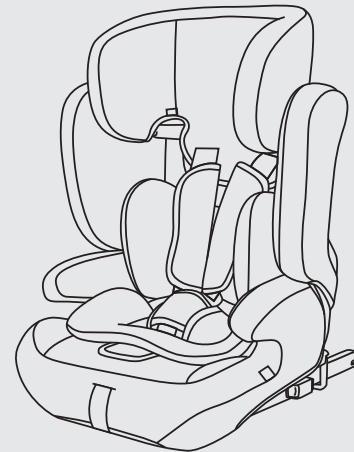

**GROUP I,II,III**

SUITABLE FOR CHILDREN

9 months to 12 years old

9~36KG

## Contents

1. Vital information-READ NOW.....	4-5
2.Safety instruction.....	6
3.Using safety seat in this way.....	6
4.Parts and interior equipment.....	7
5.Scope of application for children.....	8
6.Steps of backrest and base assembly.....	9-10
7.Using the buckle.....	10
8.How to place the safety seat.....	11
9.Adjust the harness.....	11
10.How to use the isofix guide.....	12
11.Instructions for use of cushion.....	12
<b>12.Installing the safety group I(Instalation 1)</b>	
12.1 Installing the safety car seat.....	13-15
12.2 Securing the child in the safety car seat.....	15-16
<b>13.Installing the safety group I(Instalation 2)</b>	
13.1 Installing the safety car seat.....	17-19
13.2 Securing the child in the safety car seat.....	19-21
<b>14.Installing the safety group II,III.....</b>	21-24
15.Unlock ISOFIX.....	24
16.Remove the cover.....	25-28
17.Maintenance and cleaning	
17.1 Daily maintenance.....	28
17.2 Washing instruction.....	28
18.List of approved cars.....	29-32

## PRODUCT DESCRIPTION

GROUP	METHOD OF INSTALLATION	TYPE
I	ISOFIX+ TOP TETHER	UNIVERSAL
I,II,III	3-point safety belt	UNIVERSAL
II,III	3-point safety belt+ISOFIT	SEMI- UNIVERSAL

**ISOFIT** :FIX attachment for the connection between CRS and vehicle seats which has two rigid anchorages according to UN ECE 14, but use only for Group II, III.

### Notice

1. This is a “universal”and “semi-universal” child restraint,it is approved to Regulation NO.44,04 series of amendments,for general use in vehicles and it will fit most,but not all,car seats.
2. A correct fit is likely if the vehicle manufacturer has declared in the vehicle handbook that the vehicle is capable of accepting a “Universal”child restraint for this age group.
3. This child restraint has been classified as “Universal”under more stringent conditions than those which applied to earlier designs which do not carry this notice.
4. If in doubt,consult either the child restraint manufacturer or the retailer.

**Only suitable if the vehicle is fitted with 3-point safety belts,Approved to UN/ECE Regulation No.16 or other equivalent standards.**

### NOTICE

- This is an ISOFIX CHILD RESTRAINT SYSTEM for group I with ISOFIX and top tether.It is approved to Regulation NO.44,04 series of amendments for general use in vehicles fitted with ISOFIX anchorages systems.
- It will fit vehicles with positions approved as ISOFIX positions(as detailed in the vehicle handbook),depending on the category of the child seat and of the fixture.
- The mass group and the ISOFIX size class for which this device is intended is:9-18kg,class B1

**This child restraint is classified for”(Semi-universal) for group II, III with ISOFIT, ”use and is suitable for fixing into the seat positions of the following cars:**

CAR	FRONT	REAR	
*	Outer	Outer	Centre
	NO	Yes	NO

**“\*” Please see the list of approved cars**

Seat positions in other cars may also be suitable to accept this child restraint.If in doubt,consult either the child restraint manufacturer or the retailer.

## 1. Vital information-READ NOW

For your child's safety, please read these instructions carefully before use and keep them for future reference. Failure to follow the instructions contained in this manual could result in serious injury to your child.

1. This child safety seat can only be used with the harness for children 9kg to 18kg in weight (group I: 9 - 18kg ; group II, III: 15-36 kg).
2. This instruction manual can be retained in the special space of the child seat for its life period.
3. Do not use this child safety seat at the home. It has not been designed for home use and should only be used in your car.
4. Never leave your child unattended in the child restraint system even for a short time.
5. The child safety seat should be changed when it has been subject to violent stresses in an accident.
6. This child restraint should be securely belted in the vehicle even when not in use. In a crash or sudden stop, an unsecured child safety seat may injure other occupants.
7. Always make sure that any straps holding the seat restraint to the vehicle shall be tight, any straps restraining the child should be adjusted to the child's body, and check that the straps shall not be twisted.
8. **IMPORTANT!** Ensuring that any lap straps is worn low down, so that the pelvis is firmly engaged.
9. Do not use any load bearing contact points other than those described in the instructions and marked in the child restraint, when in doubt, please contact the child restraint manufacturer..
10. Any luggage or other objects liable to cause injuries in the event of a collision shall be properly secured.
11. The rigid items and plastic parts of a child restraint must be so located and installed that they are not liable, during everyday use of the vehicle to become trapped by a moveable seat or in a door of the vehicle.

12. To prevent from the risk of fall, your child should always be fastened.

13. It is dangerous to make any alteration or additions to the device without the approval of the competent authority, and a danger of not following closely the installation instructions provided by the child restraint manufacturer.

14. This child safety seat is designed for children from 9 to 36 kg. Never overload the child safety seat more than one child or with other loads.

15. The child restraint must not be used without the cover.

16. The seat cover should not be replaced with any other than the one recommended by the manufacturer, because the cover constitutes an integral part of the restraint performance.

17. Before you adjust any movable or adjustable parts of your child safety seat, you must remove your baby from the child safety seat.

18. The child safety seat should be kept away from sunlight if the seat is not provided with a textile, otherwise it may be too hot for the child's skin.

19. Never use a second-hand product, as you can never be certain what was happened to it.

20. **Notice:** Do not use in any configuration not shown in the instructions.

21. Please identify unsatisfactory position of the adult safety belt buckle relative to the correct point of the child safety seat, if in doubt, please contact the child seat manufacturer.

22. Please also read the car manufacturer's handbook before use.

23. **Importance!** Before using ISOFIX child restraint system, please read carefully the manual of automobile manufacturer about the instruction of ISOFIX fix point.

## 2. Safety instruction

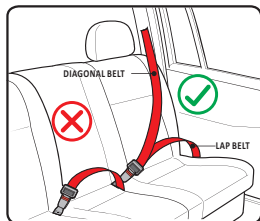

Only suitable if the approved vehicles are fitted with 3 point safety-belts, approved to UN/ECE Regulation No.16 or other equivalent standards.

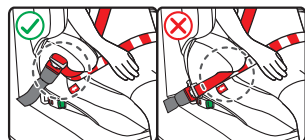

**NOTICE:** If the buckle strap of car seat is too long, the child restraint system can not be installed firmly. It is very dangerous. If any doubt, please consult the child restraint system manufacturer.

## 3. Using safety seat in this way

Forward facing traffic direction	Correct
Back facing traffic direction	Error
Vehicle is only fitted with 2-point safety belt	Error
Vehicle is fitted with 3-point safety belt	Correct
Seat beside the driver	Error
Rear seat	Correct
Rear middle seats Three-point Belt	Correct

### 3.1 Please carefully implement the Country Traffic Safety Regulations

- Do not install the child safety seat at the front seat with airbag.
- Please read the instruction manual carefully that how to use the airbag.

### NOTICE

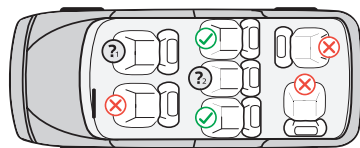

- ✔ You can install this position
- ✘ Unable to install the position
- ❓ Do not install the child safety seat at the front seat with air bag.
- ❓ Only with the three point safety belt, can this location.

## 4. Parts and interior equipment

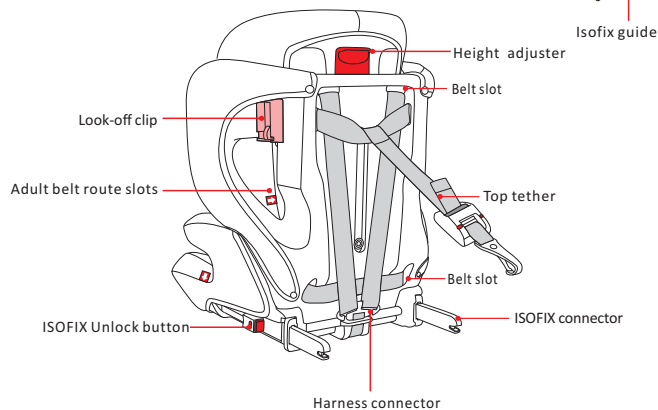
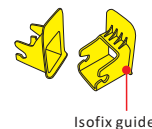
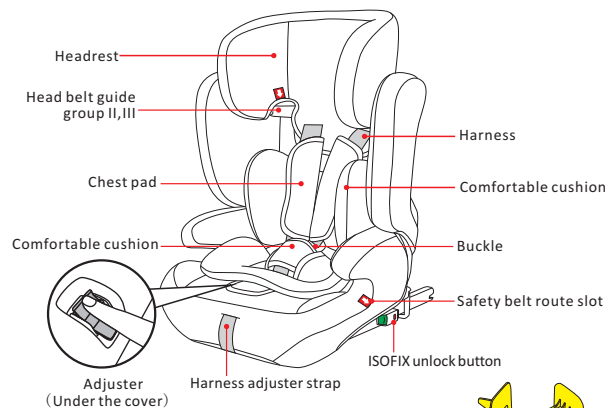

 : routing label

## 5. Scope of application for children

### GROUP I

It is suitable for the weight 9-18 kgs, given to children about 9 months-4 years old.



**Installation 1:**  
isofix+top tether  
**Securing the child:**  
5-point harness

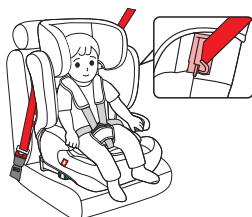

**Installation 2:**  
3-point safety belt  
**Securing the child:**  
5-point harness

### GROUP II,III

It is suitable for the weight 15-36 kgs, given to children about 4-12 years old.

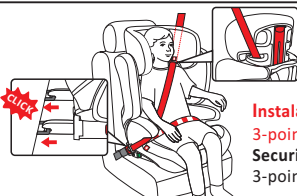

**Installation 1:**  
3-point safety belt + isofix  
**Securing the child:**  
3-point safety belt

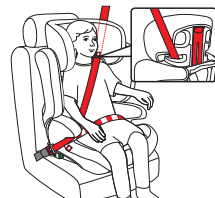

**Installation 2:**  
3-point safety belt  
**Securing the child:**  
3-point safety belt

## 6 Steps of backrest and base assembly

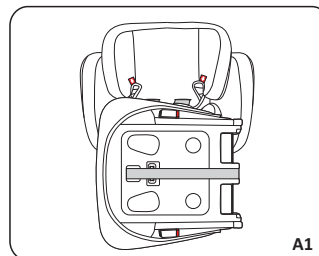

**Step 1:** Slide seat out of box

A1

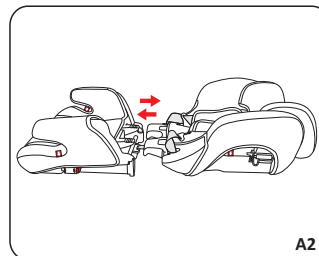

**Step 2:** Align base and backrest in a straight line.

A2

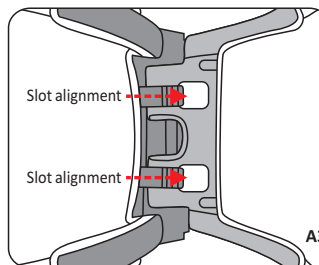

**Step 3:** Place backrest hooks inside base securely.

A3

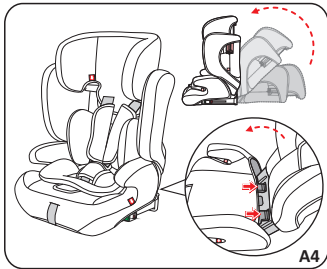

**Step 4:** Gently keep pressure on hooks as you lift backrest up.

**WARNING: DO NOT FORCE MAY CAUSE DAMAGE.**

## 7. Using the buckle

### Locking Method

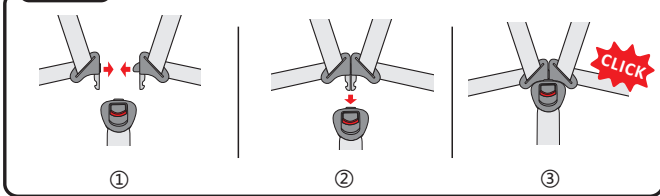

### Unlocking Method

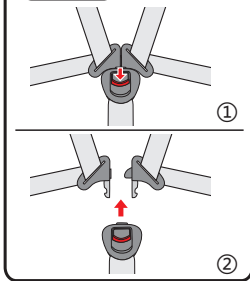

### Locking Method :

Align the left and right buckle tongues to one tongue and insert into the buckle until you hear a "Click" .

### Unlocking Method :

You can press the red button of the buckle downwards, the two metal sections will be pop up.

## 8. How to place the safety seat

**⚠ Note:** In order to keep safety, please put the restraint system on the back seat, and ensure that the backrest and the car seat nicely.

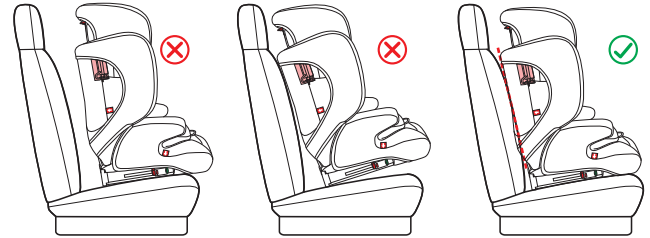

## 9. Adjust the harness

### -Loosening the shoulder harness

Press the adjuster button under the cover and at the same time pull both shoulder straps forward.

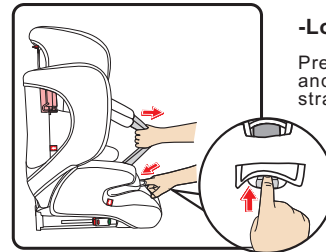

### -Tightening the harness

Pull the adjuster strap until the harness is fully tightened.

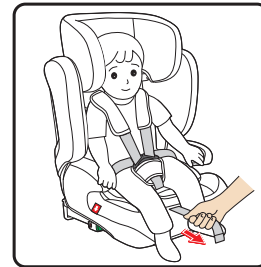

## 10. How to use the isofix guide

In order to lock the isofix connector to the steel point successfully, it can use isofix guide.

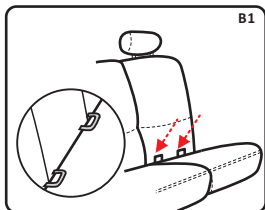

**Step 1:** Find out isofix connection in the car.

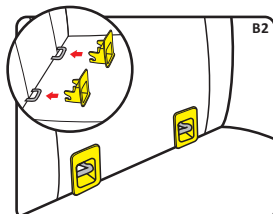

**Step 2:** Insert isofix guide into isofix connection

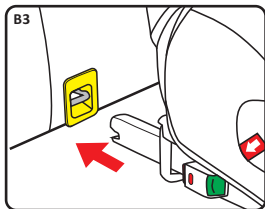

**Step 3:** Push child seat follow the direction and insert isofix connector into isofix guide(B3. B4) , Check if isofix locking system turns to green and make sure child seat is firmly connected(B4).

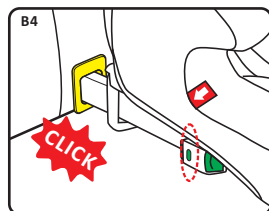

## 11. Instructions for use of cushion

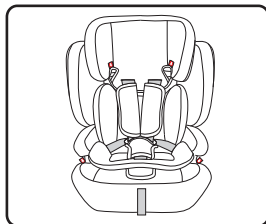
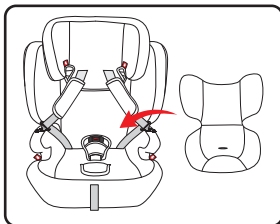

**Notice:** Please use cushion for the child less than 15 kgs  
Put cushion in child restraint system, and then adjust harness and cushion following the picture

## 12. Installing the safety group I (Installation 1)

It is suitable for the weight 9-18 kg, given to children about 9months-4 years old.

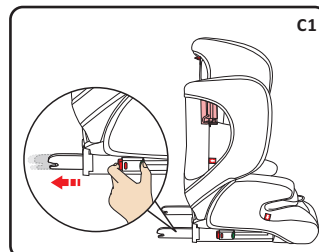

### 12.1 Install the baby car seat

**Installation:** isofix+top tether  
**Securing the child:** 5-point harness

**Step 1:** Press both button and push out the isofix connector

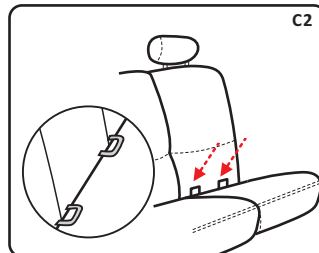

**Step 2:** Find out isofix connection in the car.

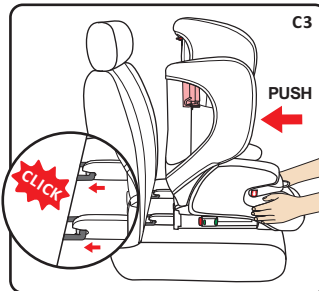

**Step 3:** Push child seat follow the direction and insert isofix connector into isofix guide(C3) .



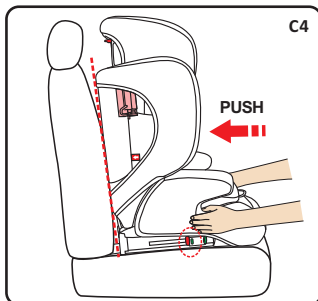

C4

**Step 4:** Check if isofix locking system turns to green and make sure child seat is firmly connected(C4).

**NOTICE:** Child safety seat must be against the car seat firmly.

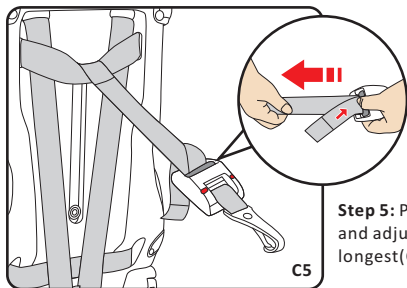
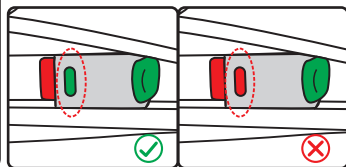

C5

**Step 5:** Press the adjusting button and adjust the belt of top tether to the longest(C5).

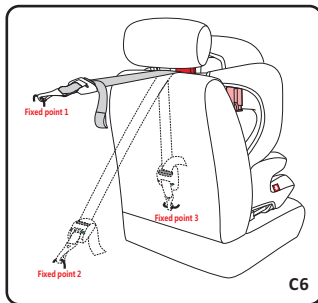

C6

**Step 6:** Connect top tether with the fixing point on the car(C6).

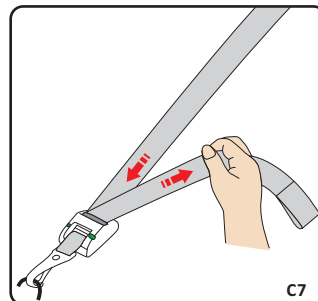

C7

**Step 7:** String the belt of top tether until the adjuster shows green(C7).  
**⚠ Notice:** Top tether is only for group I

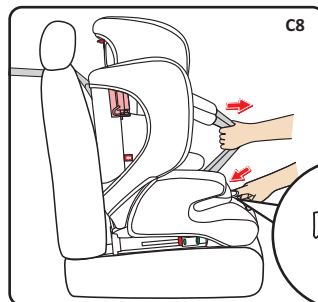
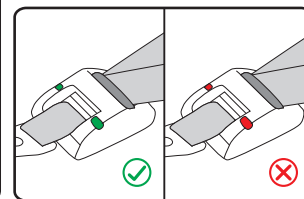

C8

**12.2 Securing the child in the safety car seat.**

**Step 1.** Loosen the harness(C8)

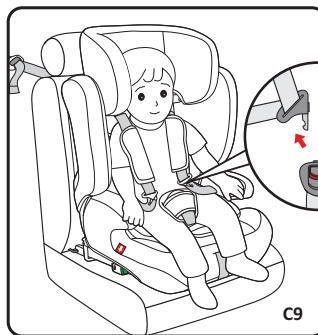

C9

**Step 2:** Release the buckle, and put the child into the safety car seat(C9).

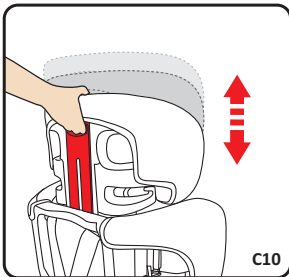

**Step 3:** Pull the height adjuster to adjust the height of the harness and the headrest according to the child's height(C10).

**⚠️ Note!** The height for the harness is adjusted by lifting the headrest(C11).

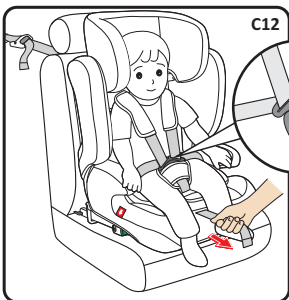
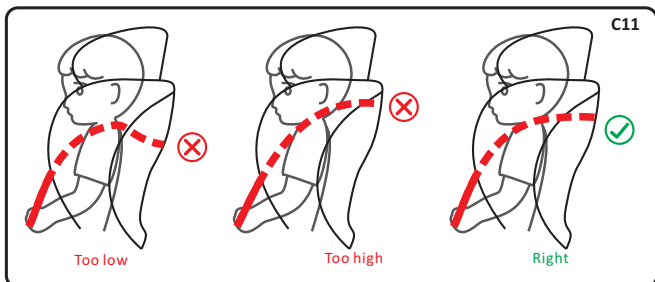

**Step 4.** Align the left and right buckle tongues to one tongue and insert into the buckle until you hear a “Click”(C12).

**Step 5:** Pull the shoulder straps upwards to remove the slack from the lap sections of the harness then pull the adjuster strap until the harness is fully tightened(C12).

## 13. Installing the safety group I (Installation 2)

It is suitable for the weight 9-18 kg, given to children about 9months-4 years old.

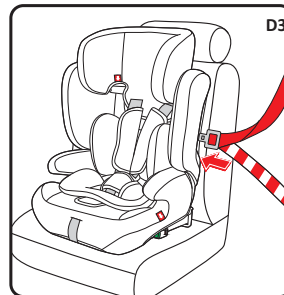
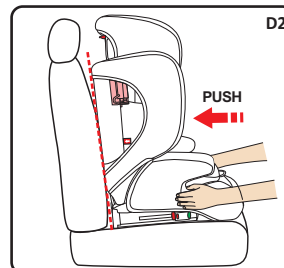
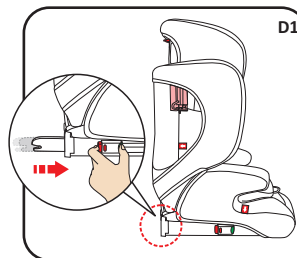

### 13.1 Install the baby car seat

**Installation:** 3-point safety belt  
**Securing the child:** 5-point harness

**Step 1:** Hide isofit in the booster(D1).

**Step 2:** Put the Child safety seat against the car seat(D2)

**Step 3:** Pull out the diagonal belt together with lap belt, through the belt route slot of backrest(D3).

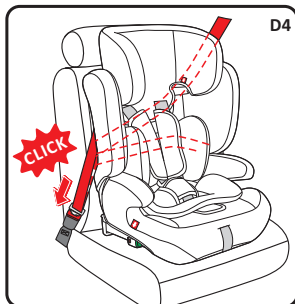

**Step 4:** Insert into car seat belt buckle hear a “CLICK” (D4).

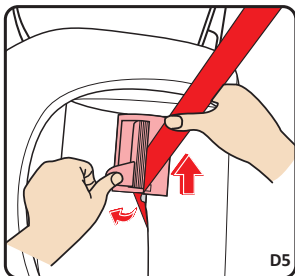

**Step 5:** Clip the diagonal belt into the locking clip. (D5, D6, D7) .

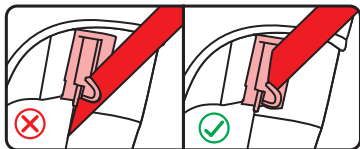
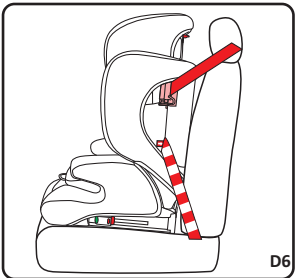

**Note!** Please refer to the following picture, clip the safety belt into the locking clip in the right way (C6, C7)

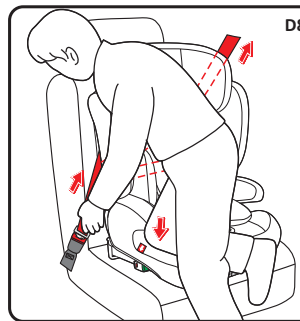
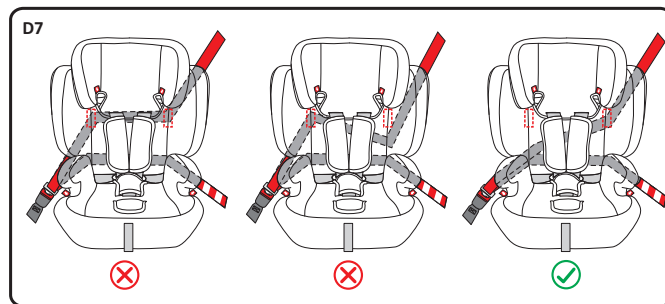

**Step 6:** Pull car seat belt follow the direction of red arrow and make sure the belt is tight enough (D8).

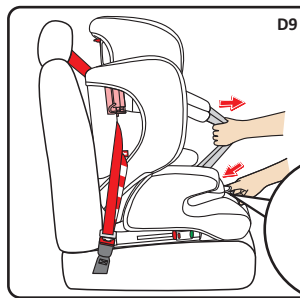
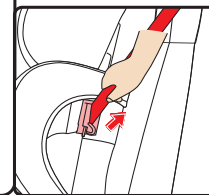

### 13.2 Securing the child in the safety car seat.

**Step 1.** Loosen the harness (D9)

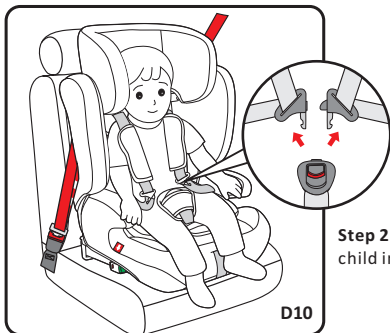

**Step 2:** Release the buckle, and put the child into the safety car seat (D10).

D10

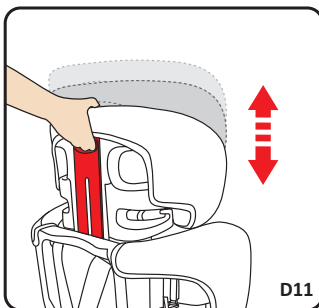

**Step 3:** Pull the height adjuster to adjust the height of the harness and the headrest according to the child's height (D11).

**⚠ Note!** The height for the harness is adjusted by lifting the headrest (D12).

D11

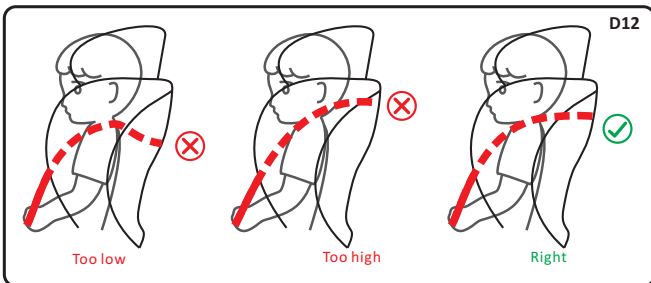

Too low

Too high

Right

D12

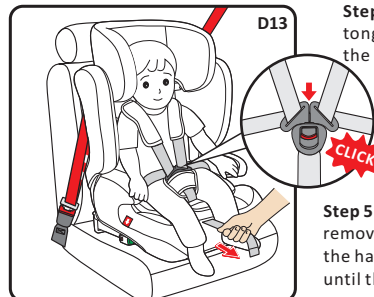

**Step 4.** Align the left and right buckle tongues to one tongue and insert into the buckle until you hear a "Click" (D13).

**Step 5:** Pull the shoulder straps upwards to remove the slack from the lap sections of the harness then pull the adjuster strap until the harness is fully tightened (D13).

D13

## 14. Installing the safety group II, III

It is suitable for the weight 15-36 kg, for children about 4-12 years old Approx. Group II, III installation can choose to use ISOFIT or not.

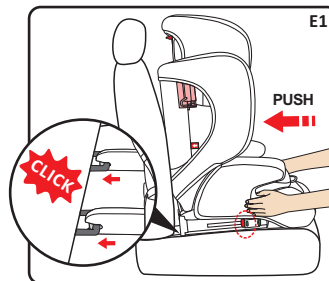

E1

### 1. Using ISOFIT:

Connect ISOFIT with anchorage point on the car seat (E1)

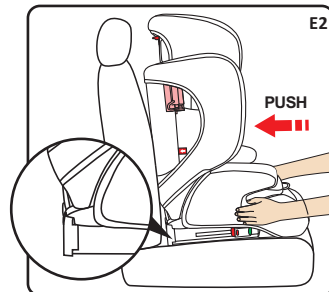
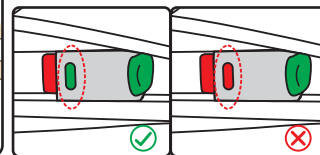

E2

### 2. Not using ISOFIT:

Hide ISOFIT in the booster. Put the seat against the car seat (E2)

E3

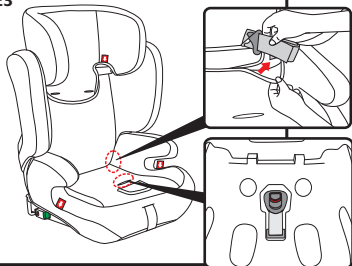

### Securing the child

**Step 1:** Follow the part 15 (see picture F1~F9) routine to remove car seat pad.

**NOTICE 1:** Fold the strap of both sides and hide under the booster cover

**NOTICE 2:** Place the buckle in the booster (under the cover).

E4

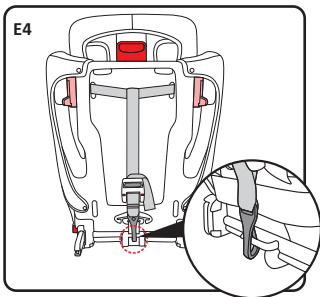

**NOTICE 3:** No need to take off the top tether. Click it onto the booster.

E5

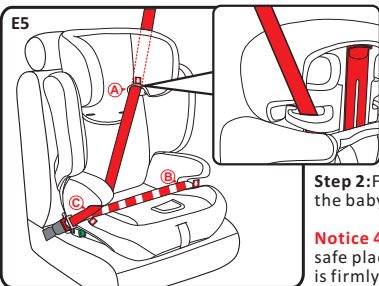

**Step 2:** Follow the E5 routine to install the baby car seat.

**Notice 4:** Stock the baby car seat in a safe place or ensure the baby car seat is firmly installed when not using it.

E6

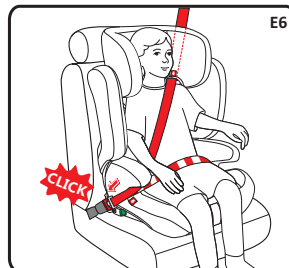

**Step 3:** Put the child in the seat and follow E5 routine.

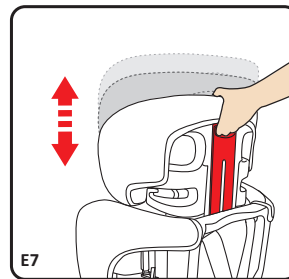

**Step 4:** Use the height adjuster to adjust the height of the headrest according to the child's height. The gap between head belt guide and baby is 2 finger width. The harness straps should be level with or just above the child's shoulders (E7, E8).

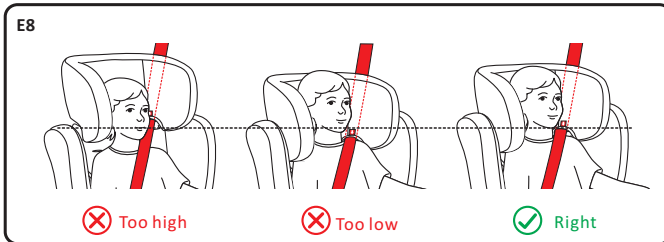

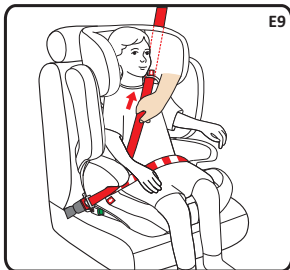

E9

**Step 5:** Fasten car seat belt and make sure, it is tight enough(E9).

**Important:** Ensuring that any lap straps is worn low down, so that the pelvis is firmly engaged, shall be stressed.

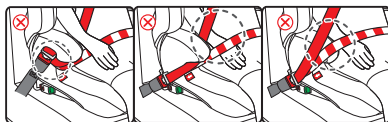

The belt buckle is too high

hand is caught

Belt goes wrong and hand is caught

## 15. Unlock ISOFIX

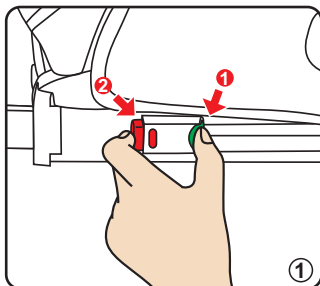

①

Press the green button first and then red button to release the isofix connector and take away the seat

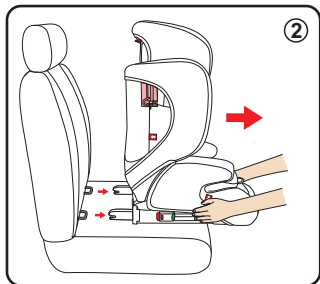

②

## 16. Remove the cover

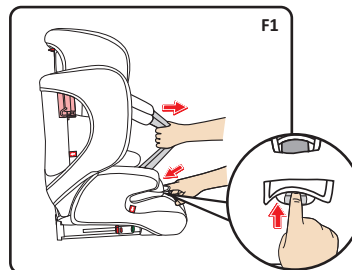

F1

**Step 1.** Loosen the harness(F1)

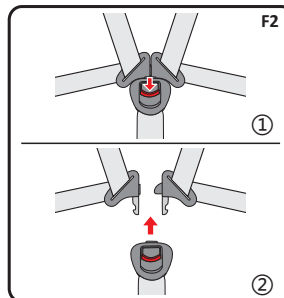

F2

①

②

**Step 2:** Release the buckle

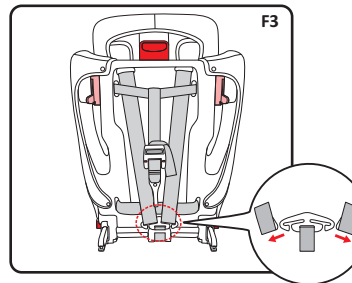

F3

**Step 3:** Slide both of the harness straps off the harness connector.

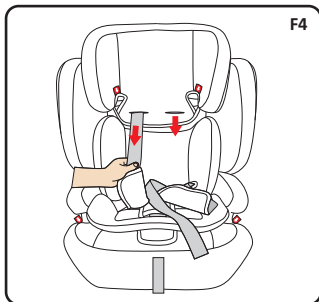

**Step 4:** Pull out the shoulder belt .

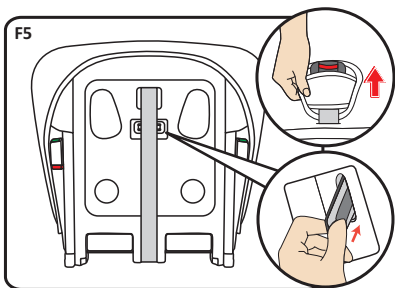

**Step 5:** Pull out the harness from the slot which under the safety car seat.

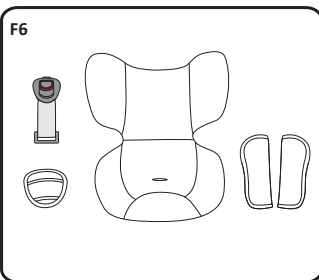

**Step 6:** Keep the removed cushion and accessories well.

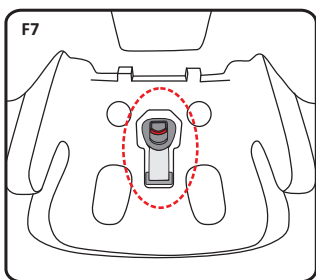

**Step 7:** Place the buckle in the booster (under the cover).

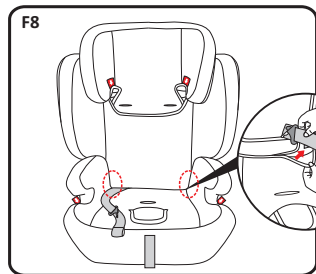

**Step 8:** Fold the strap of both sides and hide under the booster cover

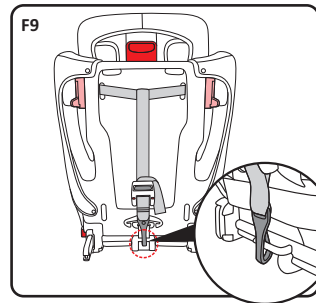

**Step 9:** Click the top tether onto the booster

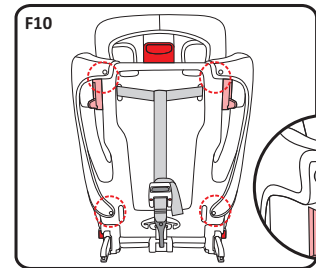

**Step 10:** Turn the seat to the back and unlock the snap fastener.

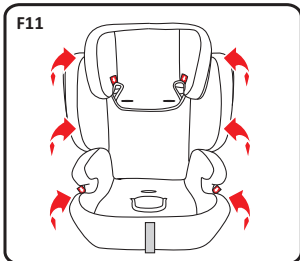

**Step 11:** Pull all directions to take out the cover(F11).

※Follow in reverse order and repeat the procedure to put on the fabric cover

## 17. Maintenance and cleaning

### 17.1 Daily maintenance

1. In daily use, check periodically the child seat. The child seat should be replaced after an accident.
2. Please keep this child seat in dry and ventilated place to avoid damp moldy.
3. If the child seat becomes dusty, clean the seat belt and the plastic pieces by swiping them with a damp sponge and let it dry naturally.
4. If food or drink drop accidentally on the buckle, disassemble the seat belt from the child seat and rinse it gently by warm water. Leave it dry naturally.
5. For cleaning the entire child seat fabric cover, please refer to the 17.2 washing instructions.

### 17.2 Washing instruction

Never use any solvent, chemical detergent or lubricant on any part of your child seat.



## 18. List of approved cars

The following vehicle list is only for reference. If your vehicle does not in the list, before using, please consult with the retailer or manufacturer.

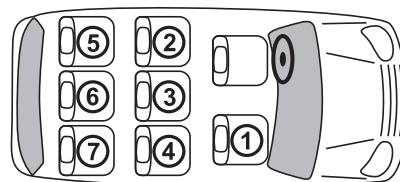

Saloon



No. of doors



Estate



No. of seat



Convertible



Before you purchase the vehicle, check that it is equipped with the appropriate anchorages



Hatchback



MPV



Year of manufacture



Coupe



Maximum body height



Approved seats





























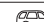

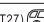

ALFA ROMEO		★	
156 Sportwagon/ Crosswagon 04	1997 2007		②④
159 Sportwagon	2005 2011		②④
Giulietta 940	2010		②④
GT Sportcoupe	2004 2010		②④
MiTo	2008		①②④
BMW		★	
1(E87/E82/E81)  3+5	2005		②④
1(E82)	2007		②④
1(E88)	2008		①②④
3(E90)	2005		②④
3(E92)	2005		②④
3	08/05		②④
5(F10)	2010		②④
5(F11) Touring	2010		②④
5 GT	10/09		②④
7(E65) (Facelift 2005)	2001 2008		②④
7(F01)	2008		②④
Mini Club Man	2007		②④
Mini Countryman	2010		②④
Mini Countryman	2010		④
X1	10/09		②④
X5	2006		②④
X6	2008		②④
Z4	2002	ISOFIX	①
DACIA		★	
Duster	2010		②④
Lodgy	2012		②③④

Logan	2004		②④
Sandero	2008		②④
Sandero Stepway	2009		②④
Sandero Live 2	2012		②④
FORD		★	
B-MAX	2012		②④
C-MAX	2011		②④
C-MAX	2003 2010		②④
Fiesta(MK7)  3+5	2008		②④
Fiesta	2012		②④
Focus	2011		②④
Focus	2004 2010		②④
Focus Turnier	2008 2010		②④
Kuga	2013		②④
Mondeo Turnier	2007		②④
Ranger	2011		②④
S-Max(Facelift 2010)	2006		②③④
Tourneo Connect	2002 2013		②④
Transit Custom	2012		②③⑥
HYUNDAI		★	
Accent  3+5	2000 2005		②④
Coupe	1999 2002		②④
Elantra  5	2000 2006		②④
Getz	2002 2009		②④
H 1	2007		②④
i 10	2008		②④
i 20	2008		②④
ix20	2010		②④

i 30	2007 2012		②④
i 35	2009		②④
i 40	2011		②④
Matrix	2001 2010		②④
KIA		★	
Carens	2006 2013		②④
Carnival	2005		②④⑤⑦
Ceed	2006 2012		②④
Ceed	2012		②④
Cerato	2004 2008		②④
Opirus	2003 2010		②④
Magentis	2001 2005		②④
Picanto	2004 2011		②④
Rio	2005 2011		②④
Rio	2011		②④
Soul	2008		②④
LEXUS		★	
GS	1997 2005		②④
IS	1998 2005		②④
IS	2005 2013		②④
RX	2003 2009		②④
MAZDA		★	
2 DY	2003 2007		②④
2 DE	2007		②④
2	2013		②④
3 BL	2003 2009		②④

3 BK	2009 2013		②④
5	2005 2010		②④
5 CW	2010		②④
6	2002 2007		②④
6	2008 2012		②④
CX 7	2006 2009		②④
CX 7	2009		②④
MX 5	1998 2005		①
MPV	1999 2005		
Premacy	1999 2005		②④
RX 8	2003 2012		②④
MERCEDES-BENZ		★	
A	05/05		②④
B (Facelift 2008)	06/05		②④
C (Facelift 2004)	2000 2007		②④
C (W204)	2007		②④
C (S204)	2007		②④
C (204)	03/11		②④
E (W212;S212)	2009		②④
E (C207)	2009		②④
GLK	2008		②④
ML (W164)	07/05		②④
R (W251/V251)	12/05		②④⑤⑦
SKODA		★	
Citigo	2011		②④
Fabia I	1999 2007		②④

Fabia I  	1999 2007	② ④	IQ	2009	② ④
Fabia II  	2007	② ④	Land Cruiser	2002 2009	② ④
Felicia  	1994 2001	② ④	Land Cruiser	2009	② ④
Octavia I  	2000 2010	① ② ④	Previa/Estima	2000 2006	② ④
Octavia II  	2004 2012	① ② ④	Previa/Estima	2006	② ④
Octavia III  	2013	① ② ④	Prius	2003 2009	② ④
Octavia Scout 	2007 2012	② ④	Prius(+Facelift)	2009	② ④
Rapid	2012	② ④	RAV 4	2000 2006	② ④
Roomster(+Facelift)	2006	② ④	RAV 4	2006 2013	② ④
Superb I	2001 2008	② ④	Urban Cruiser	2009	② ④
Superb II  <sup>1</sup> 	2008	② ④	<b>VOLVO *</b>		
Yeti	2009	② ④	C 30	2006 2012	 137m ② ④
<b>SUBARU *</b>			C 70	2005 2013	② ④
Forester	2008 2013	② ④	XC 70	2003	② ④
Impreza  	2007 2012	② ④	S 40/V 40	1995 2004	② ④
Legacy  	2003 2009	② ④	S 40/V 40	2004 2012	② ④
Outback	2003 2009	② ④	S 60	2000 2009	② ④
Outback	2009	② ④	S 60	2010	② ④
Trezia	2011	② ④	S 80	1998 2006	② ④
<b>TOYOTA *</b>			S 80 (+Facelift)	2006	② ④
Auris	2007 2012	② ④	V 50	2004 2007	② ④
Auris Hybrid	2010	② ④	V 50	2007 2012	② ④
Avensis(T25)  	2003 2009	② ④	V 60	2010	 137m ② ④
Avensis(T27)  	2009	② ④	V 70 	2000 2007	② ④
Corolla 	1997 2002	② ④	V 70  / XC70 (+Facelift)	2007	② ④
Corolla  	2002 2009	② ④	XC 60	2008	② ④
Corolla  	2006	② ④			