

NINGBO LONGMA VEHICLE INDUSTRY CO.,LTD.

Add:No.29 kandun East Road ,Cixi,Avenue,Sansizao Village,

Kandun Sub-District,Cixi City,Zhejiang Province.

Tel:0086-574-23670081 23670083

Fax:0086-0574-63288372

Http://www.loma-cardle.com

E-mail:sales@loma-cardle.com

P.C:315303

INSTRUCTION FOR USE

Congratulations on your purchase of the child seat.Please read this instruction manual carefully before use.If you have any questions concerning the use of this child seat,please do not hesitate to contact us.

CHILD RESTRAINT WITH ISOFIX LM230

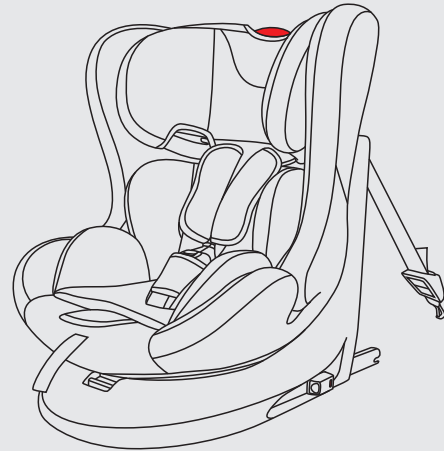

GROUP 0+,I,II,III
SUITABLE FOR CHILDREN
LESS THAN 36 KG

⚠ WARNING:DO NOT place rear-facing child seat on front seat with airbag.DEATH OR SERIOUS INJURY can occur.

Contents

1. Vital information-READ NOW.....	3-4
2.Safety instruction.....	5
3.Using safety seat in this way.....	5
4.Parts and interior equipment.....	6
5.Scope of application for children.....	7
6.Height adjustment for head support and shoulder harnesses.....	8
7.Using the buckle.....	9
8.Unlock ISOFIX.....	9
9.Adjust the harness.....	10
10.Adjust the backrest angle.....	10
11.Instruction for seat rotation.....	11
12.How to use the isofix guide.....	12
13. Instructions for use of cushion.....	12
14.Installation of the child seat group 0+,I.....	13-17
15.Installation of the child seat group I.....	18-21
16.Installation of the child seat group II,III.....	21-26
17.Remove the cover.....	27-29
18.Maintenance and cleaning.....	30
19.List of approved cars.....	31-34

DIRECTION	GROUP	METHOD OF INSTALLATION	TYPE
Rearward	0+,I	ISOFIX+TOP TETHER	SEMI-UNIVERSAL
Forward	I	ISOFIX+TOP TETHER	UNIVERSAL
Forward	II,III	ISOFIT+3-point safety belt	SEMI-UNIVERSAL
Forward	II,III	3-point safety belt	UNIVERSAL

Notice regarding Universal category (Group 0+ I II III)

1. This is a “Universal” child restraint. It is approved to Regulation No. 44, 04 series of amendments, for general use in vehicles and it will fit most, but not all, car seats.
2. A correct fit is likely if the vehicle manufacturer has declared in the vehicle handbook that the vehicle is capable of accepting a “Universal” child restraint for this age group.
3. This child restraint has been classified as “Universal” under more stringent conditions than those which applied to earlier designs which do not carry this notice.
4. If in doubt, consult either the child restraint manufacturer or the retailer.

Notice regarding Semi-universal category (Group II III)

This child restraint is classified for "(Restricted/Semi-universal)" use and is suitable for fixing into the seat positions of the following cars:

CAR	FRONT	REAR
Refer to vehicle list	Outer	Centre
	Yes	Yes NO

Seat positions in other cars may also be suitable to accept this child restraint. If in doubt, consult either the child restraint manufacturer or the retailer.

Only suitable if the approved vehicles are fitted with 3 point with retractor safety-belts, approved to UN/ECE Regulation No. 16 or other equivalent standards.

Notice regarding Universal ISOFIX child restraint system (in Group 0+,I)

1. This is an ISOFIX CHILD RESTRAINT SYSTEM. It is approved to Regulation No. 44, 04 series of amendments for general use in vehicles fitted with ISOFIX anchorages systems.
2. It will fit vehicles with positions approved as ISOFIX positions (as detailed in the vehicle handbook), depending on the category of the child seat and of the fixture.
3. The mass group and the ISOFIX size class for which this device is intended is: Group 0+, D Group I, B1

1. Vital information-READ NOW

For your child's safety, please read these instructions carefully before use and keep them for future reference. Failure to follow the instructions contained in this manual could result in serious injury to your child.

1. This child safety seat can only be used with the harness for children 0 to 36kg in weight (group 0+, I: 0 - 18kg ; group I: 9-18 kg ; group II, III: 15-36 kg).
2. This instruction manual can be retained in the special space of the child seat for its life period.
3. Do not use this child safety seat at the home. It has not been designed for home use and should only be used in your car.
4. Never leave your child unattended in the child restraint system even for a short time.
5. The child safety seat should be changed when it has been subject to violent stresses in an accident.
6. This child restraint should be securely belted in the vehicle even when not in use. In a crash or sudden stop, an unsecured child safety seat may injure other occupants.
7. Always make sure that any straps holding the seat restraint to the vehicle shall be tight, any straps restraining the child should be adjusted to the child's body, and check that the straps shall not be twisted.

8. **IMPORTANT!** Ensuring that any lap straps is worn low down, so that the pelvis is firmly engaged.

9. Do not use any load bearing contact points other than those described in the instructions and marked in the child restraint, when in doubt, please contact the child restraint manufacturer.

10. Any luggage or other objects liable to cause injuries in the event of a collision shall be properly secured.

11. The rigid items and plastic parts of a child restraint must be so located and installed that they are not liable, during everyday use of the vehicle to become trapped by a moveable seat or in a door of the vehicle.

12. To prevent from the risk of fall, your child should always be fastened.

13. It is dangerous to make any alteration or additions to the device without the approval of the competent authority, and a danger of not following closely the installation instructions provided by the child restraint manufacturer.

14. This child safety seat is designed for children from 9 to 36 kg. Never overload the child safety seat more than one child or with other loads.

15. The child restraint must not be used without the cover.

16. The seat cover should not be replaced with any other than the one recommended by the manufacturer, because the cover constitutes an integral part of the restraint performance.

17. Before you adjust any movable or adjustable parts of your child safety seat, you must remove your baby from the child safety seat.

18. The child safety seat should be kept away from sunlight if the seat is not provided with a textile, otherwise it may be too hot for the child's skin.

19. Never use a second-hand product, as you can never be certain what has happened to it.

20. **Notice:** Do not use in any configuration not shown in the instructions.

21. **Importance! Before using ISOFIX child restraint system, please read carefully the manual of automobile manufacturer about the instruction of ISOFIX fix point.**

2. Safety instruction

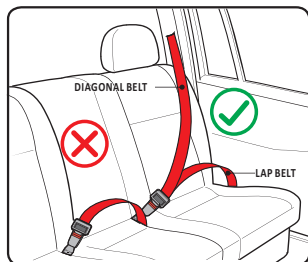

Only suitable if the approved vehicles are fitted with 3 point safety-belts, approved to UN/ECE Regulation No.16 or other equivalent standards.

3. Using safety seat in this way

Forward facing traffic direction	Correct
Back facing traffic direction	Error
Vehicle is only fitted with 2-point safety belt	Error
Vehicle is fitted with 3-point safety belt	Correct
Seat beside the driver	Error
Rear seat	Correct
Rear middle seats Three-point Belt	Correct

3.1 Please carefully implement the Country Traffic Safety Regulations

- Do not install the child safety seat at the front seat with airbag.
- Please read the instruction manual carefully that how to use the airbag.

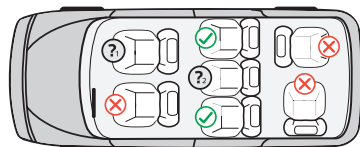



NOTICE

- ✔ You can install this position
- ✘ Unable to install the position
- ❓ Do not install the child safety seat at the front seat with air bag.
- ❓ Only with the three point safety belt, can this location.

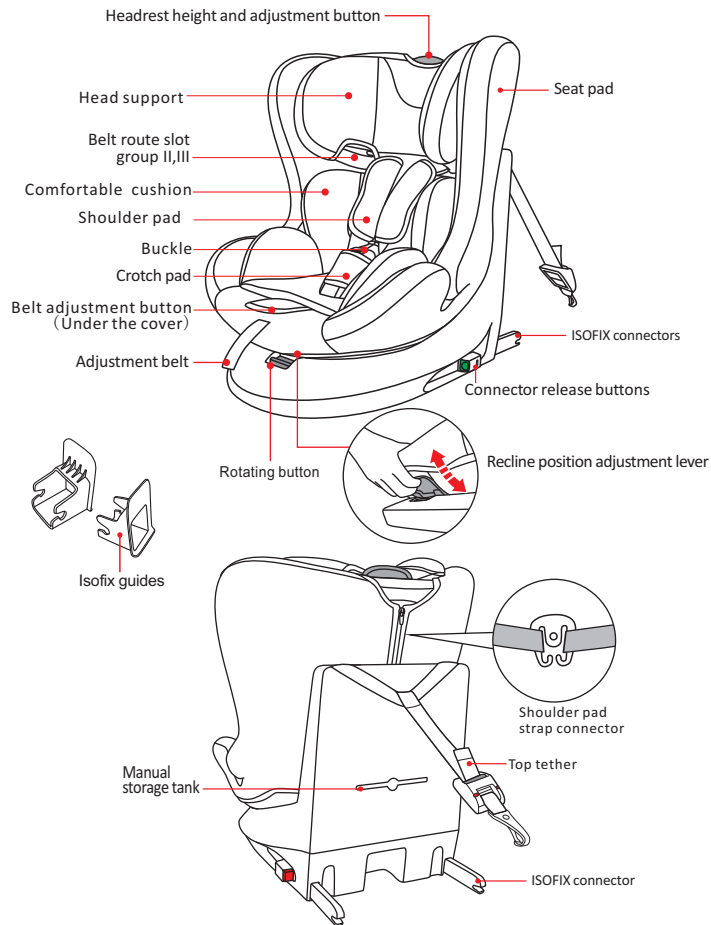
4. Parts and interior equipment

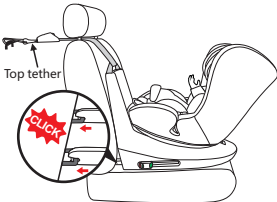
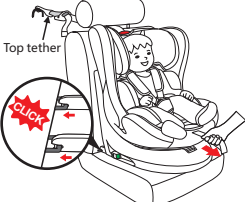

5. Scope of application for children

<p>GROUP 0+,I (Rearward facing mode)</p> <p>It is suitable for the weight 0-18 kg, given to children about 0-4 years old.</p>	 <p>Top tether</p> <p>Installation : isofix+top tether Securing the child: 5-point harness</p>
<p>GROUP I (Forward facing mode)</p> <p>It is suitable for the weight 9-18 kg, given to children about 9 months~4years old.</p>	 <p>Top tether</p> <p>Installation : isofix+top tether Securing the child: 5-point harness</p>
<p>GROUP II,III (Forward facing mode)</p> <p>It is suitable for the weight 15-36 kgs, given to children about 4-12 years old.</p>	 <p>Installation 1 : isofix+3-point safety belt Securing the child: 3-point safety belt</p>  <p>Installation 2 : 3-point safety belt Securing the child: 3-point safety belt</p>

6. Height adjustment for head support and shoulder harnesses

Please adjust the head support and check if the shoulder harnesses are at the correct height for your child.

Notice:When used rear facing and forward facing,the shoulder harness height must be even with or just above the child's shoulders



NO-Too low



NO-Too high



YES-Correct

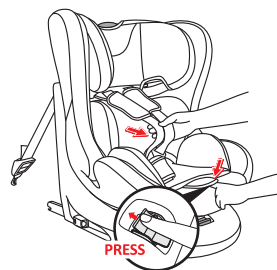

Step 1: Press the adjuster button under the cover and at the same time pull both shoulder straps forward.

Step 2: Pull the height adjuster to adjust the height of the harness and the headrest according to the child's height.

Notice!The height for the harness is adjusted by lifting the headrest.

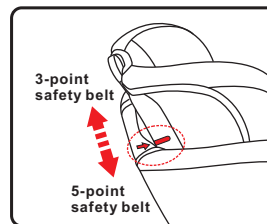
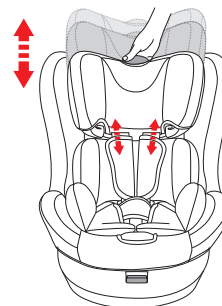

Notice:When using child restrain system, check the shoulder height of the child time by time and adjust the height of headrest. When the height of harness exceeds the point, it has to take the 5-point harness away (Refer to figures D3 to D8 on pages 22 to 23 of the manual) and use car seat belt to install (Refer to figures D12 to D16 on pages 25 to 26 of the manual)

7. Using the buckle

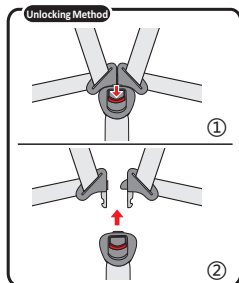
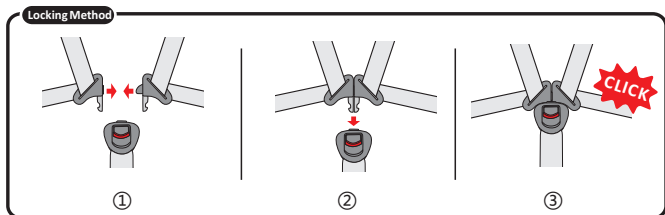

Locking Method :

Align the left and right buckle tongues to one tongue and insert into the buckle until you hear a "Click" .

Unlocking Method :

You can press the red button of the buckle downwards, the two metal sections will be pop up.

8. Unlock ISOFIX

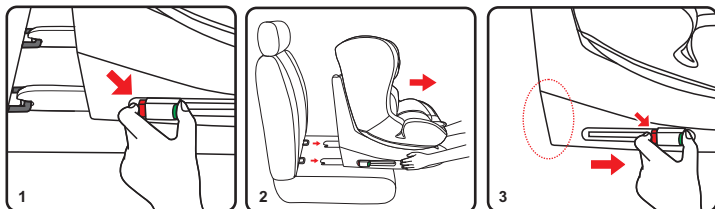

To remove from the vehicle press the ISOFIX adjuster button (fig.1) and pull the base back from the seat (fig.2)

Transit to prevent damage during. Press the ISOFIX adjuster button and fold the connector completely (fig.3)

9. Adjust the harness

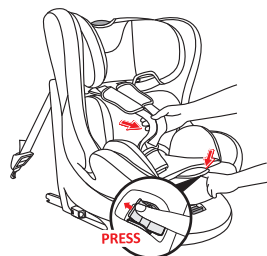

-Loosening the shoulder harness

Press the adjuster button under the cover and at the same time pull both shoulder straps forward.



-Tightening the shoulder harness

Pull the adjuster strap until the harness is fully tightened.

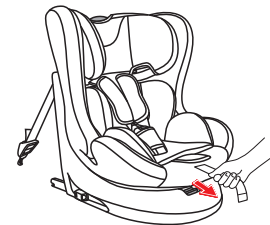

10. Adjust the backrest angle

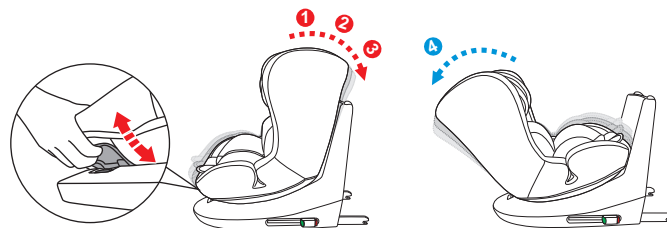

The forward and rearward installation of the safety seat has three adjustable angles. Please select the appropriate tilt angle according to the following different installation groups.

Rearward installation (group 0+, I): 4th gear

Forward installation (group I): 1st-3rd gear

Forward installation (Group II, III): 1st gear

NOTICE: When the safety seat is installed in rearward direction, the tilt angle can be adjusted in three gears, but only the 4th gear can be used.

How to use: lift up the angle adjusting handle under the front of the seat, then pull it forward or push it backward. When the desired gear is reached, release the angle adjusting handle, and finally push the seat until the "click" sound is heard.

11. Instructions for seat rotation

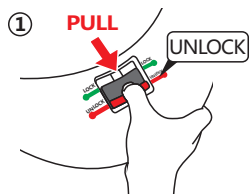

Step 1: Pull the swivel button, make the seat unlocked

Step 2: Single hand rotate the baby car seat

NOTICE :

Please pull the swivel button again, when the seat can not be swidled into place .

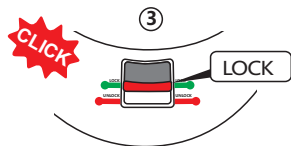
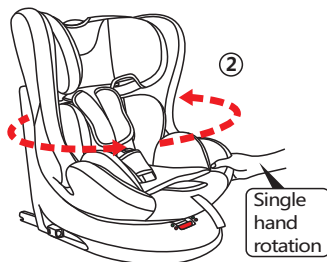

Step 3: When heard "CLICK", the base is locked.

NOTICE :

Please make sure the seat is locked and can not rotate before driving



WARNING

- During driving, seat is not allowed to rotate to the side facing position. Side facing position will not protect the child in case a collision.
- Backrest can only be locked with base when turn to forward facing and rearward facing and it can not be locked when turn to the side.

12. How to use the isofix guide

In order to lock the isofix connector to the steel point successfully, it can use isofix guide.

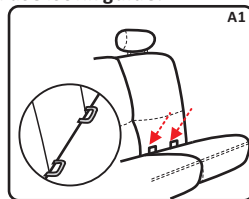

Step 1: Find out ISOFIX connection in the car.

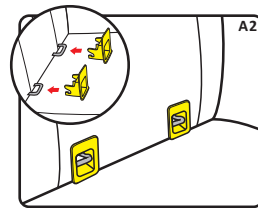

Step 2: Insert ISOFIX guides to assist with installation

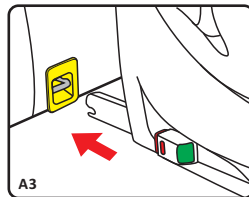

Step 3: Make sure that both ISOFIX connectors are securely attached to their ISOFIX anchor points.

Notice 1: Make sure that both ISOFIX connectors are securely attached to their ISOFIX anchor points. The colors of the indicators on the both ISOFIX connectors should be completely green

Notice 2: Check to make sure the base is securely installed by pulling on the both ISOFIX connectors.

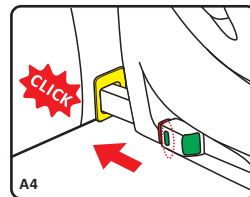

13. Instructions for use of cushion

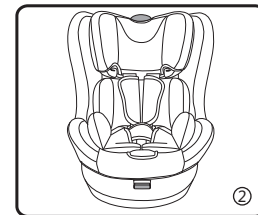
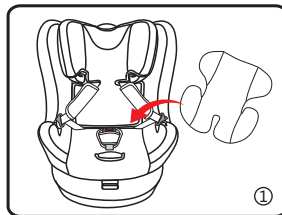

NOTICE: Please use cushion for the child less than 15kgs
Put cushion in child restraint system, and then adjust harness and cushion following the picture

14. Installation of the child seat group 0+,I

It is suitable for the weight 0-18 kg, given to children about 0-4 years old.

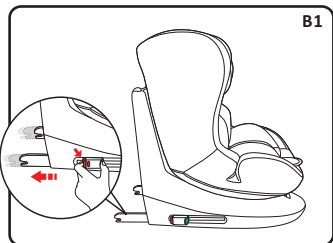

B1



Step 1: Press the ISOFIX adjuster button to extend the ISOFIX(B1)

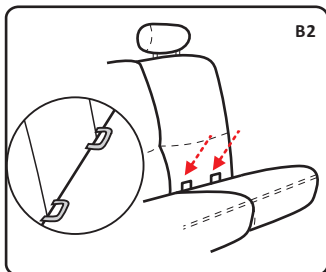

B2

Step 2: Find out ISOFIX connection in the car(B2).

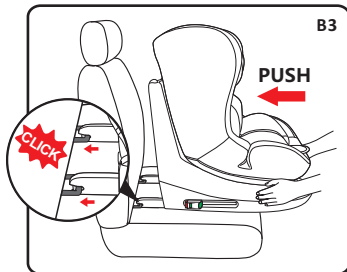

B3

Step 3: Push child seat follow the direction ,until isofix connectors are completely locked with the connection device of car(B3).

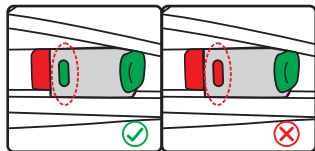

NOTICE: Make sure that both ISOFIX connectors are securely attached to their ISOFIX anchor points. The colors of the indicators on the both ISOFIX connectors should be completely green

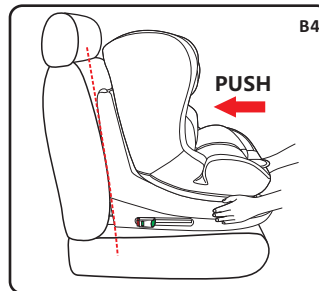

B4

Step 4: child safety seat must be against the car seat firmly(B4) .

Notice: The child safety seat not be against the car seat, It is very dangerous.

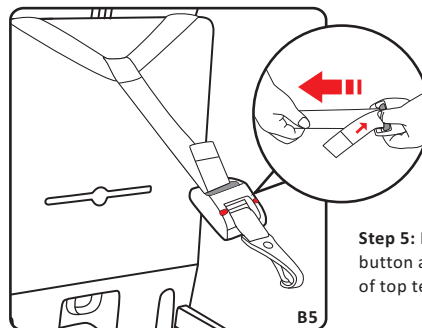

B5

Step 5: Press the adjusting button and adjust the belt of top tether to the longest(B5).

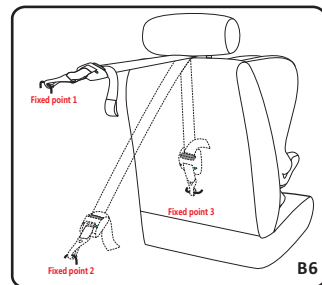

B6

Step 6: Connect top tether with the fixing point on the car(B6)

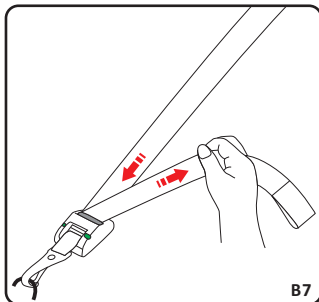

Step 7: String the belt of top tether until the adjuster shows green(B7).
⚠️ Roll up the extra ribbons and put them away to prevent baby from playing, It is very dangerous.

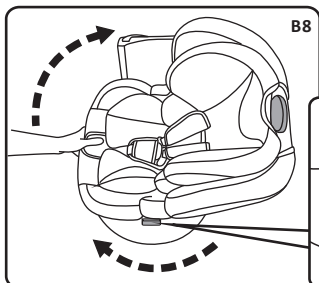
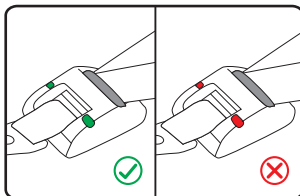

Step 8: Pull the button ,rotate the baby car seat to the side facing position(B8,B9).

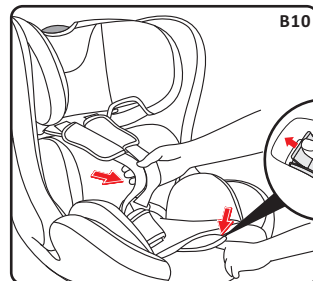
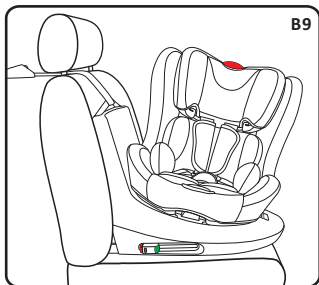
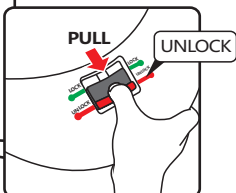

Step 9: Press the webbing adjustment button,while pulling out the shoulder harnesses to the proper length(B10)

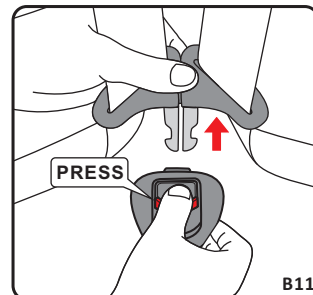

Step 10:Unlock the buckle of the harnesses by pressing the red button(B11)

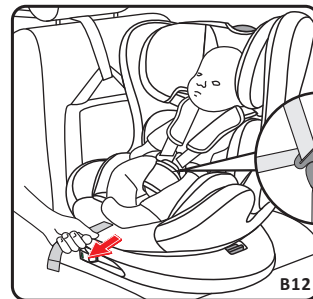

Step 11:Put the child into the seat and fasten the harness ,then pull the adjuster strap until the harness is fully tightened(B12).

Notice 1:Check that the harness does not twisted.

Notice 2: During driving, seat is not allowed to rotate to the side facing position. Side facing position will not protect the child in case a collision.

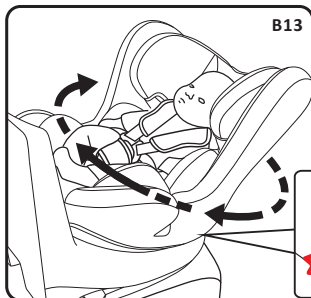

B13

Step 12: Use one hand to pull out the adjuster, mean while use the other hand to rotate the seat, Keep the seat in rearward position (B13).

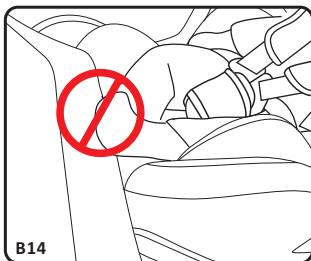
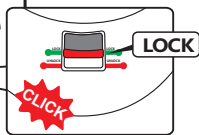

B14

NOTICE:

1. backrest can only be locked with base when turn to forward facing and rearward facing and it can not be locked when turn to the side.
2. Please pull the swivel button again, when the seat can not be swivelled into place .
3. Please make sure the seat is locked and can not rotate before driving
4. When rotating the seat, please take care of the child's feet.

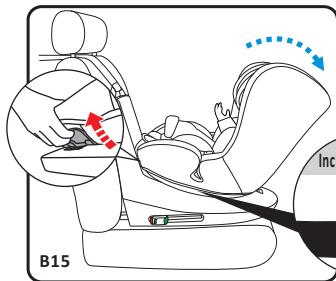

B15

Step 13: Finally, put the safety seat tilt angle adjustment to reverse 4th gear

NOTICE: When the safety seat is installed in rearward direction, the tilt angle can be adjusted in three gears, but only the 4th gear can be used.

Important- Do not using forward-facing before the child's weight exceeds 9 kg.

15. Installation of the child seat group I

It is suitable for the weight 9-18 kg, given to children about 9 months-4 years old.

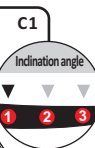
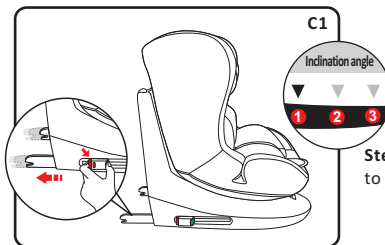

B1

Step 1: Press the ISOFIX adjuster button to extend the ISOFIX (Fig.C1)

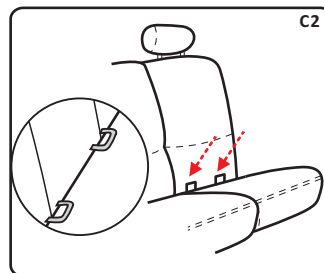

C2

Step 2: Find out ISOFIX connection in the car (C2).

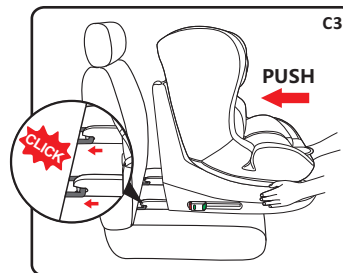

C3

Step 3: Push child seat follow the direction, until ISOFIX connectors are completely locked with the connection device of car.

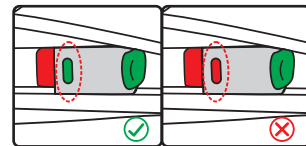

NOTICE: Make sure that both ISOFIX connectors are securely attached to their ISOFIX anchor points. The colors of the indicators on the both ISOFIX connectors should be completely green

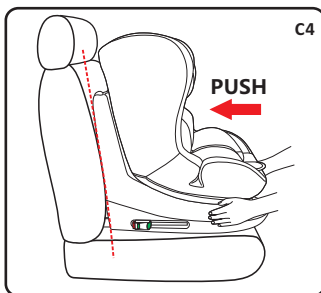

C4

Step 4: child safety seat must be against the car seat firmly(C4) .

Notice:The child safety seat not be against the car seat. It is very dangerous

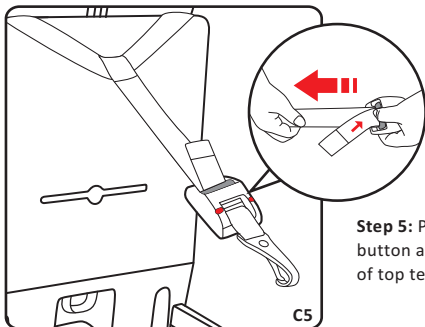
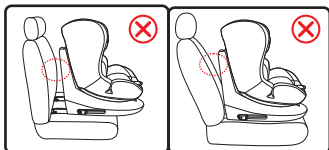

C5

Step 5: Press the adjusting button and adjust the belt of top tether to the longest(C5).

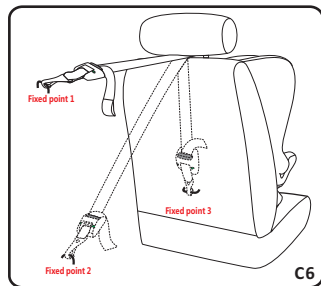

C6

Step 6: Connect top tether with the fixing point on the car

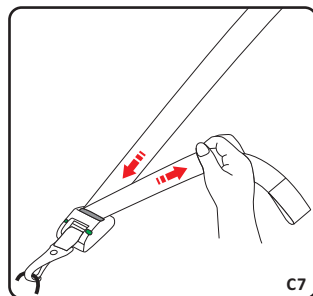

C7

Step 7: String the belt of top tether until the adjuster shows green(C7).
⚠️ Roll up the extra ribbons and put them away to prevent baby from playing, It is very dangerous.

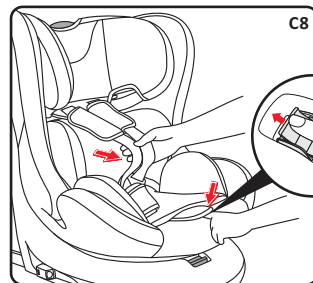
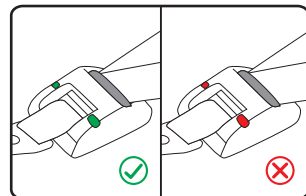

C8

Step 8: Press the webbing adjustment button,while pulling out the shoulder harnesses to the proper length(C8)

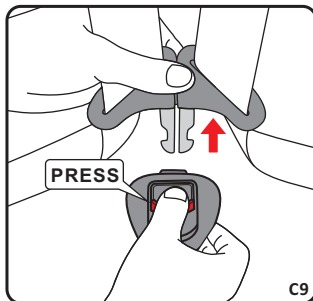

C9

Step 9:Unlock the buckle of the harnesses by pressing the red button(C9)

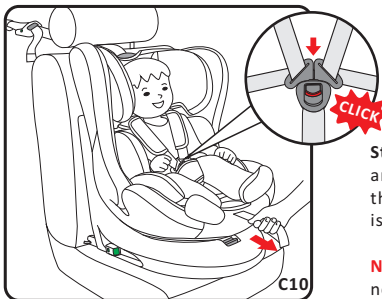

Step 10: Put the child into the seat and fasten the harness, then pull the adjuster strap until the harness is fully tightened(C10).

Notice: Check that the harness does not twisted.

16. Installation of the child seat group II,III

It is suitable for the weight 15-36 kg, for children about 4-12 years old Approx.

Group II,III installation can choose to use ISOFIT or not, but no use top tether.

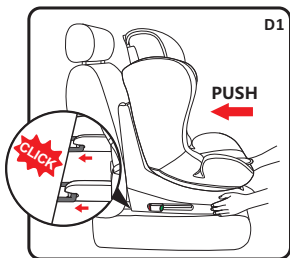

1. Using ISOFIT:

Connect ISOFIT with anchorage point on the car seat(D1)

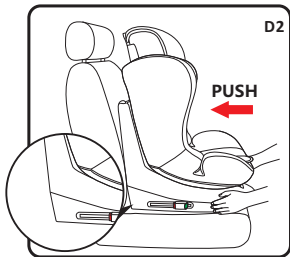
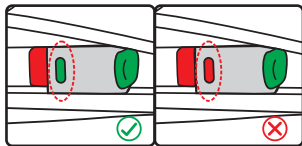

2. Not using ISOFIT:

Hide ISOFIT in the booster. Put the seat against the car seat(D2)

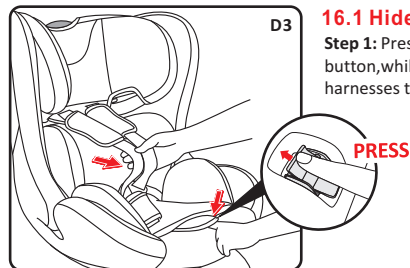

16.1 Hide 5-point harness system

Step 1: Press the webbing adjustment button, while pulling out the shoulder harnesses to the proper length(D3)

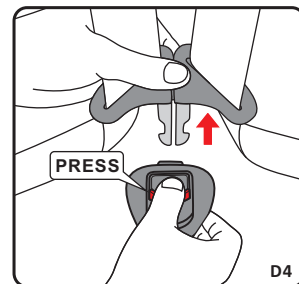

Step 2: Release the buckle(D4)

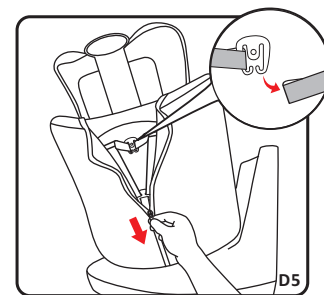

Step 3: Slide unilateral of the harness straps off the harness connector(D5).

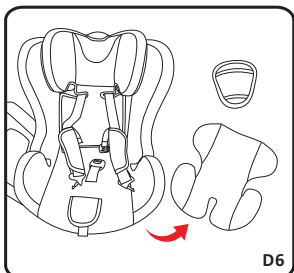

Step 4: keep the removed cushion and accessories well(D6).

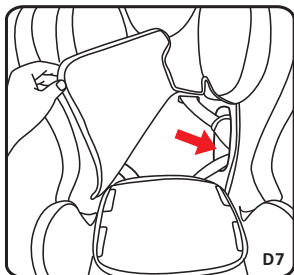

Step 5: open the fabric cover of backrest and get the harness go through the hole(D7).

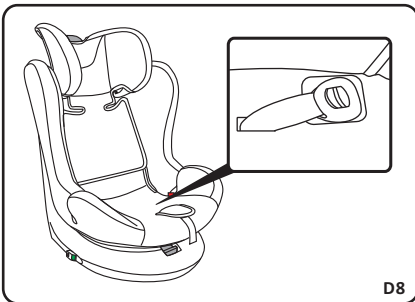

Step 6: Place the buckle in the booster (under the cover)(D8).

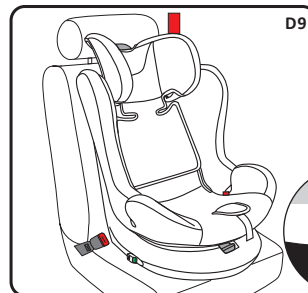

16.2 Securing the child

Step 1: Put the seat against the car seat(D9)

Notice: The child safety seat not be against the car seat. It is very dangerous

Notice: Adjust the seat angle to first gear.

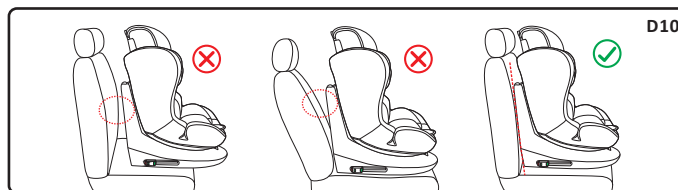

Step 2: Put the child in the seat (D11) and follow D12, D13 routine ① ② ③ to securing the child.

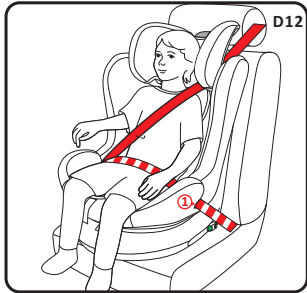

D12



D13

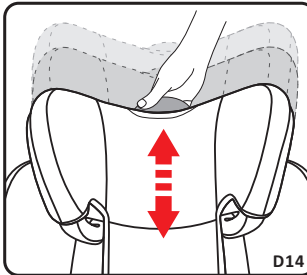

D14

Step 3: Use the height adjuster to adjust the height of the headrest according to the child's height. The gap between head belt guide and baby is 2 finger width. The harness straps should be level with or just above the child's shoulders (D14, D15).

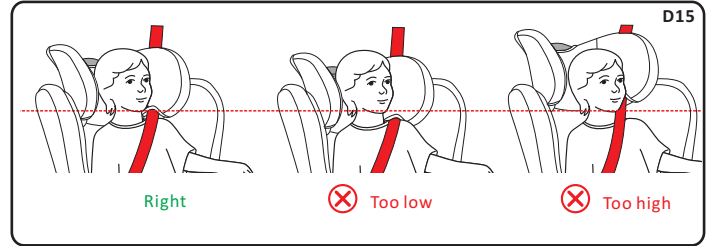

D15

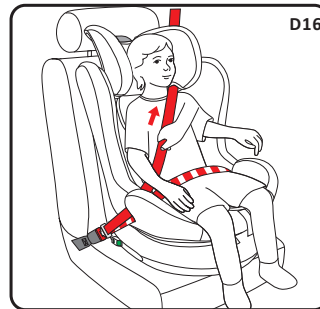

D16

Step 5: Fasten car seat belt and make sure, it is tight enough (D16).

Important: Ensuring that any lap straps is worn low down, so that the pelvis is firmly engaged, shall be stressed.

17. Remove the cover

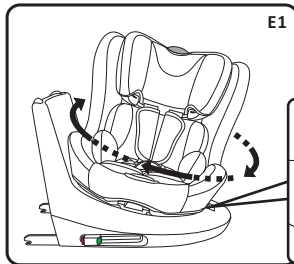

Step 1: Pull the button, rotate the baby car seat to the side facing position(E1).

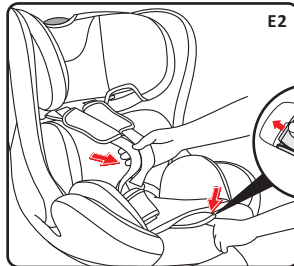
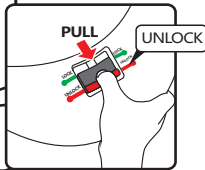

Step 2: Loosening the shoulder harness(E2)

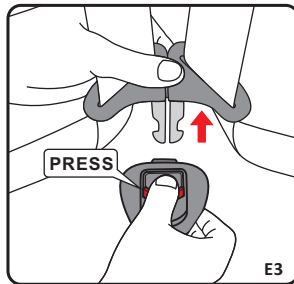

Step 3: Release the buckle(E3)

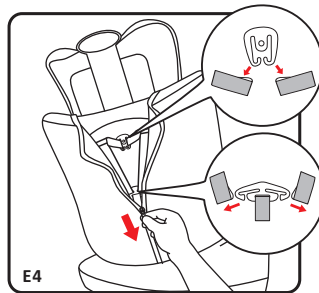

Step 4: Slide both of the harness straps off the harness connector(E4).

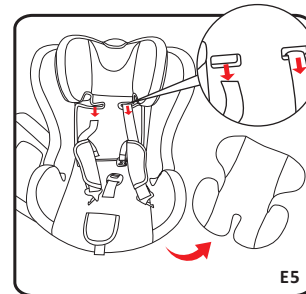

Step 5: Pull out the shoulder belt, keep the removed cushion and accessories well(E5,E6).

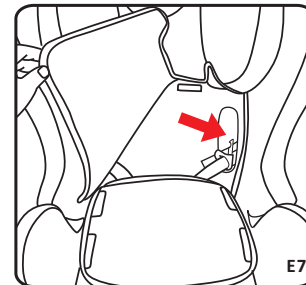
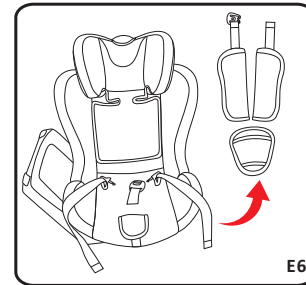

Step 6: open the fabric cover of backrest and get the harness go through the hole(E7).

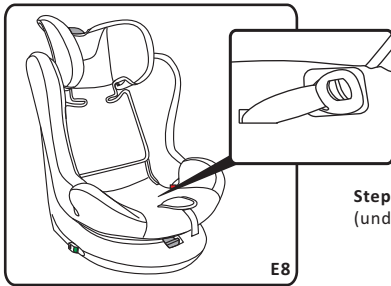

Step 7: Place the buckle in the booster (under the cover)(E8).

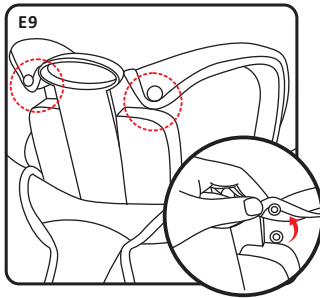

Step 8: Unlock the snap fastener(E9)

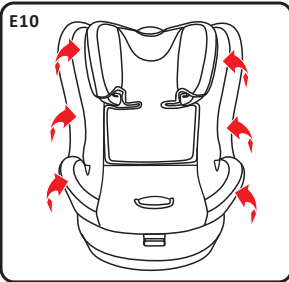

Step 9: pull all directions to take out the cover(E10).

※ Follow in reverse order and repeat the procedure to put on the fabric cover

18. Maintenance and cleaning

18.1 Daily maintenance

1. In daily use, check periodically the child seat. The child seat should be replaced after an accident.
2. Please keep this child seat in dry and ventilated place to avoid damp moldy.
3. If the child seat becomes dusty, clean the seat belt and the plastic pieces by swiping them with a damp sponge and let it dry naturally.
4. If food or drink drop accidentally on the buckle, disassemble the seat belt from the child seat and rinse it gently by warm water. Leave it dry naturally.
5. For cleaning the entire child seat fabric cover, please refer to the 18.2 washing instructions.

18.2 Washing instruction

Never use any solvent, chemical detergent or lubricant on any part of your child seat.



19. List of approved cars

The following vehicle list is only for reference. If your vehicle does not in the list, before using, please consult with the retailer or manufacturer.

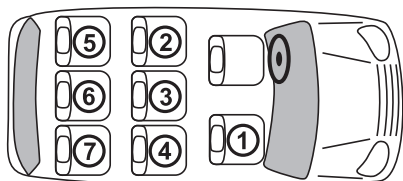

Saloon



Estate



Convertible



Hatchback



MPV



Coupe



No. of doors



No. of seat



Before you purchase the vehicle, check that it is equipped with the appropriate anchorages



Year of manufacture





















Maximum body height





















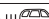



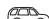

②④ Approved seats

ALFA ROMEO			*
156 Sportwagon / Crosswagon Q	1997 2007		②④
159 Sportwagon	2005 2011	1.37m	②④
Giulietta 940	2010	1.37m	②④
GT Sportcoupe	2004 2010	1.37m	②④
MiTo	2008	1.37m	①②④
BMW			*
1(E87/E82/E81)	3+5	2005	②④
1(E82)		2007	②④
1(E88)		2008	①②④
3(E90)		2005	②④
3(E92)		2005	②④
3		08/05	②④
5(F10)		2010	②④
5(F11) Touring		2010	②④
5 GT		10/09	②④
7(E65) (Facelift 2005)		2001 2008	②④
7(F01)		2008	②④
Mini Club Man		2007	②④
Mini Countryman	L 4	2010	②④
Mini Countryman	L 5	2010	④
X1		10/09	②④
X5		2006	②④
X6		2008	1.35m ②④
Z4		2002	ISOFIX ①
DACIA			*
Duster		2010	②④
Lodgy		2012	②③④

Logan		2004	②④
Sandero		2008	②④
Sandero Stepway		2009	②④
Sandero Live 2		2012	②④
FORD			*
B-MAX		2012	②④
C-MAX		2011	②④
C-MAX		2003 2010	②④
Fiesta(MK7)	3+5	2008	1.37m ②④
Fiesta		2012	1.37m ②④
Focus		2011	②④
Focus		2004 2010	1.37m ②④
Focus Turnier		2008 2010	②④
Kuga		2013	②④
Mondeo Turnier		2007	②④
Ranger		2011	②④
S-Max(Facelift 2010)		2006	②③④
Tourneo Connect		2002 2013	②④
Transit Custom		2012	②③④
HYUNDAI			*
Accent	3+5	2000 2005	②④
Coupe		1999 2002	②④
Elantra	5	2000 2006	②④
Getz		2002 2009	②④
H 1		2007	②④
i 10		2008	②④
i 20		2008	②④
ix20		2010	②④

i 30  	2007 2012	②④
i 35	2009	②④
i 40	2011	②④
Matrix	2001 2010	②④
KIA *		
Carens	2006 2013	②④
Carnival	2005	②④⑤⑦
Ceed  	2006 2012	②④
Ceed  	2012	②④
Cerato	2004 2008	②④
Opirus	2003 2010	②④
Magentis	2001 2005	②④
Picanto	2004 2011	②④
Rio	2005 2011	②④
Rio	2011	②④
Soul	2008	②④
LEXUS *		
GS	1997 2005	 137m ②④
IS	1998 2005	 137m ②④
IS	2005 2013	 137m ②④
RX	2003 2009	②④
MAZDA *		
2 DY	2003 2007	②④
2 DE	2007	②④
2	2013	②④
3 BL	2003 2009	②④

3 BK	2009 2013	②④
5  7	2005 2010	②④
5 CW	2010	②④
6  	2002 2007	 137m ②④
6  	2008 2012	 137m ②④
CX 7	2006 2009	②④
CX 7	2009	②④
MX5  5	1998 2005	①
MPV  6+7	1999 2005	
Premacy	1999 2005	②④
RX 8	2003 2012	②④
MERCEDES-BENZ *		
A	05/05	②④
B (Facelift 2008)	06/05	②④
C (Facelift 2004) 	2000 2007	②④
C (W204) 	2007	②④
C (S204) 	2007	②④
C (204)	03/11	②④
E (W212;S212)  	2009	②④
E (C207) 	2009	②④
GLK	2008	②④
ML (W164)	07/05	②④
R (W251/V251)	12/05	②④⑤⑦
SKODA *		
Citigo	2011	 137m ②④
Fabia I  	1999 2007	②④

Fabia I  	1999 2007	②④
Fabia II  	2007	②④
Felicia  	1994 2001	②④
Octavia I  	2000 2010	①②④
Octavia II  	2004 2012	①②④
Octavia III  	2013	①②④
Octavia Scout 	2007 2012	②④
Rapid	2012	②④
Roomster(+Facelift)	2006	②④
Superb I	2001 2008	②④
Superb II  	2008	②④
Yeti	2009	②④
SUBARU *		
Forester	2008 2013	②④
Impreza  	2007 2012	②④
Legacy  	2003 2009	②④
Outback	2003 2009	②④
Outback	2009	②④
Trezia	2011	②④
TOYOTA *		
Auris	2007 2012	②④
Auris Hybrid	2010	②④
Avensis(T25)  	2003 2009	②④
Avensis(T27)  	2009	②④
Corolla 	1997 2002	②④
Corolla  	2002 2009	②④
Corolla  	2006	②④

IQ	2009	②④
Land Cruiser	2002 2009	②④
Land Cruiser	2009	②④
Previa/Estima	2000 2006	②④
Previa/Estima	2006	②④
Prius	2003 2009	②④
Prius(+Facelift)	2009	②④
RAV 4	2000 2006	②④
RAV 4	2006 2013	②④
Urban Cruiser	2009	②④
VOLVO *		
C 30	2006 2012	 137m ②④
C 70	2005 2013	②④
XC 70	2003	②④
S 40/V 40	1995 2004	②④
S 40/V 40	2004 2012	②④
S 60	2000 2009	②④
S 60	2010	②④
S 80	1998 2006	②④
S 80 (+Facelift)	2006	②④
V 50	2004 2007	②④
V 50	2007 2012	②④
V 60	2010	 137m ②④
V 70 	2000 2007	②④
V 70  / XC70(+Facelift)	2007	②④
XC 60	2008	②④