

NINGBO LONGMA VEHICLE INDUSTRY CO.,LTD.

Add:#25-29 Kandun east Road, Cixi Avenue, Cixi City,  
Ningbo, China.

Tel:0086-574-23670081 23670083

Fax:0086-0574-63288372

Http://www.loma-cardle.com

E-mail:sales@loma-cardle.com

P.C:315303

# INSTRUCTION FOR USE

Congratulations on your purchase of the child seat. Please read this instruction manual carefully before use. If you have any questions concerning the use of this child seat, please do not hesitate to contact us.

## CHILD RESTRAINT LM311

**WITH ISOFIX**

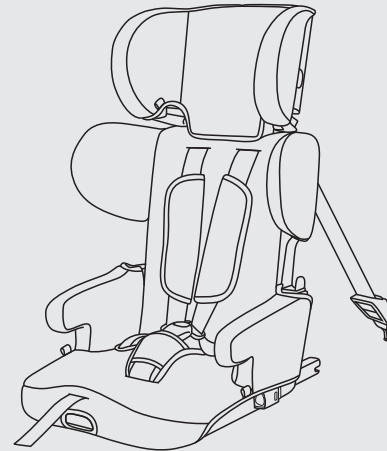

**GROUP I,II,III**  
SUITABLE FOR CHILDREN  
9 months to 12 years old  
9~36KGS

## Contents

1. Vital information-READ NOW.....	3-4
2. Safety instruction.....	5
3. Using safety seat in this way.....	5
4. Parts and interior equipment.....	6
5. Scope of application for children.....	7
6. Assembling the seat.....	8-9
7. Setting the shoulder belt height(group I).....	10-11
8. Height adjustment of headrest.....	12
9. Using the buckle.....	12
10. Installing the safety group I.....	13-18
10.1 Instalation: isofix+top tether.....	13-16
10.2 Instalation: 3-point safety belt.....	17-18
11. Installing the safety group II,III.....	19-22
11.1 Remove the buckle and belt.....	19-20
11.2 Install the baby car seat.....	21-20
11.3 Securing the child.....	22-23
12. Unlock ISOFIX.....	24
13. Folding way.....	25-26
14. Take off the fabric cover.....	27-28
15. Maintenance and cleaning.....	29
15.1 Daily maintenance.....	29
15.2 Washing instruction.....	29
16. List of approved cars.....	30-33

## PRODUCT DESCRIPTION

GROUP	METHOD OF INSTALLATION	TYPE
I	ISOFIX+TOP TETHER	UNIVERSAL
I,II,III	3-point safety belt	UNIVERSAL
II,III	3-point safety belt+ISOFIT	SEMI- UNIVERSAL

**ISOFIT** :FIX attachment for the connection between CRS and vehicle seats which has two rigid anchorages according to UN ECE 14, but use only for Group II, III.



### Notice

1. This is a “universal” and “semi-universal” child restraint, it is approved to Regulation NO.44,04 series of amendments, for general use in vehicles and it will fit most, but not all, car seats.
2. A correct fit is likely if the vehicle manufacturer has declared in the vehicle handbook that the vehicle is capable of accepting a “Universal” child restraint for this age group.
3. This child restraint has been classified as “Universal” under more stringent conditions than those which applied to earlier designs which do not carry this notice.
4. If in doubt, consult either the child restraint manufacturer or the retailer.

**Only suitable if the vehicle is fitted with 3-point safety belts, Approved to UN/ECE Regulation No.16 or other equivalent standards.**

### NOTICE

- This is an ISOFIX CHILD RESTRAINT SYSTEM for group I with ISOFIX and top tether. It is approved to Regulation NO.44,04 series of amendments for general use in vehicles fitted with ISOFIX anchorages systems.
- It will fit vehicles with positions approved as ISOFIX positions (as detailed in the vehicle handbook), depending on the category of the child seat and of the fixture.
- The mass group and the ISOFIX size class for which this device is intended is: 9-18kg, class B1

**This child restraint is classified for " (Semi-universal) for group II, III with ISOFIX, "use and is suitable for fixing into the seat positions of the following cars:**

CAR	FRONT	REAR	
*	Outer	Outer	Centre
	NO	Yes	NO

**"\*" Please see the list of approved cars**

Seat positions in other cars may also be suitable to accept this child restraint. If in doubt, consult either the child restraint manufacturer or the retailer.

## 1. Vital information-READ NOW

For your child's safety, please read these instructions carefully before use and keep them for future reference. Failure to follow the instructions contained in this manual could result in serious injury to your child.

1. This child safety seat can only be used with the harness for children 9kg to 18kg in weight (group I: 9 - 18kg ; group II, III: 15-36 kg).
2. This instruction manual can be retained in the special space of the child seat for its life period.
3. Do not use this child safety seat at the home. It has not been designed for home use and should only be used in your car.
4. Never leave your child unattended in the child restraint system even for a short time.
5. The child safety seat should be changed when it has been subject to violent stresses in an accident.
6. This child restraint should be securely belted in the vehicle even when not in use. In a crash or sudden stop, an unsecured child safety seat may injure other occupants.
7. Always make sure that any straps holding the seat restraint to the vehicle shall be tight, any straps restraining the child should be adjusted to the child's body, and check that the straps shall not be twisted.
8. **IMPORTANT!** Ensuring that any lap straps is worn low down, so that the pelvis is firmly engaged.
9. Do not use any load bearing contact points other than those described in the instructions and marked in the child restraint, when in doubt, please contact the child restraint manufacturer.
10. Any luggage or other objects liable to cause injuries in the event of a collision shall be properly secured.
11. The rigid items and plastic parts of a child restraint must be so located and installed that they are not liable, during everyday use of the vehicle to become trapped by a moveable seat or in a door of the vehicle.

12. To prevent from the risk of fall, your child should always be fastened.

13. It is dangerous to make any alteration or additions to the device without the approval of the competent authority, and a danger of not following closely the installation instructions provided by the child restraint manufacturer.

14. This child safety seat is designed for children from 9 to 36 kg. Never overload the child safety seat more than one child or with other loads.

15. The child restraint must not be used without the cover.

16. The seat cover should not be replaced with any other than the one recommended by the manufacturer, because the cover constitutes an integral part of the restraint performance.

17. Before you adjust any movable or adjustable parts of your child safety seat, you must remove your baby from the child safety seat.

18. The child safety seat should be kept away from sunlight if the seat is not provided with a textile, otherwise it may be too hot for the child's skin.

19. Never use a second-hand product, as you can never be certain what happened to it.

20. **Notice:** Do not use in any configuration not shown in the instructions.

21. Please identify unsatisfactory position of the adult safety belt buckle relative to the correct point of the child safety seat, if in doubt, please contact the child seat manufacturer.

22. Please also read the car manufacturer's handbook before use.

## 2. Safety instruction

Only suitable if the approved vehicles are fitted with 3-point safety-belts, approved to UN/ECE Regulation No.16 or other equivalent standards.

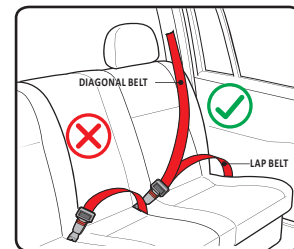

## 3. Using safety seat in this way

Forward facing traffic direction	Correct
Back facing traffic direction	Error
Vehicle is only fitted with 2-point safety belt	Error
Vehicle is fitted with 3-point safety belt	Correct
Seat beside the driver	Error
Rear seat	Correct
Rear middle seats Three-point Belt	Correct

### 3.1 Please carefully implement the Country Traffic Safety Regulations

- Do not install the child safety seat at the front seat with airbag.
- Please read the instruction manual carefully that how to use the airbag.

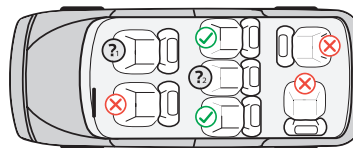

### NOTICE

- ✓ You can install this position
  - ✗ Unable to install the position
  - ?
  - ?
  - ?
- Do not install the child safety seat at the front seat with air bag.
- Only with the three point safety belt, can this location.

## 4. Parts and interior equipment

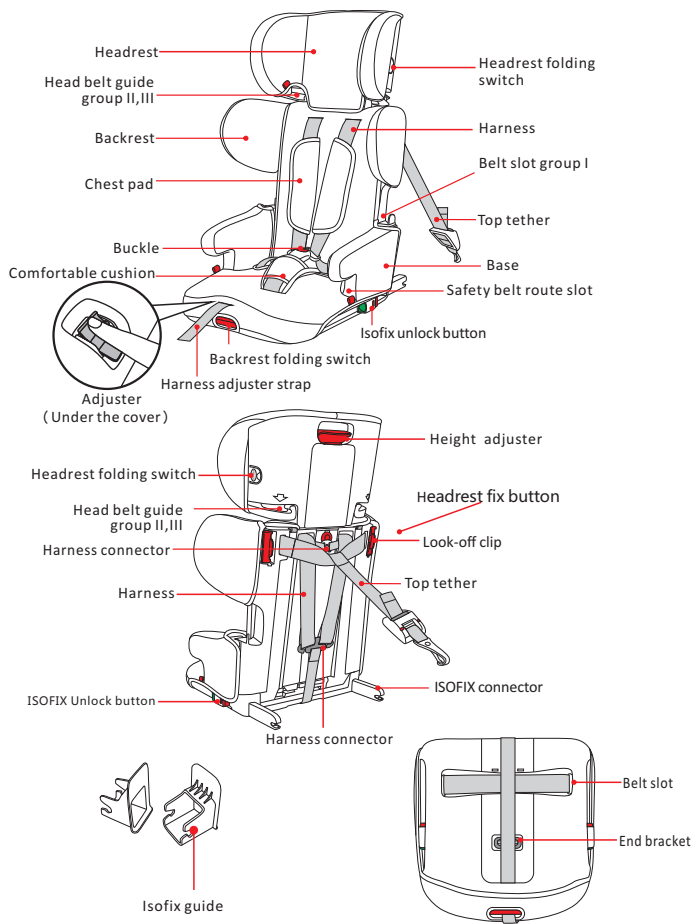

## 5. Scope of application for children

### GROUP I

It is suitable for the weight 9-18 kgs, given to children about 9 months-4 years old.

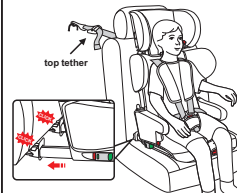

**Installation:**  
isofix+top tether  
**Securing the child:**  
5-point harness

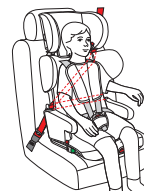

**Installation:**  
3-point safety belt  
**Securing the child:**  
5-point harness

### GROUP II, III

It is suitable for the weight 15-36 kgs, given to children about 4-12 years old.

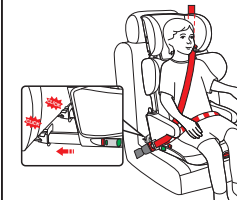

**Installation:**  
3-point safety belt + isofix  
**Securing the child:**  
3-point safety belt



**Installation:**  
3-point safety belt  
**Securing the child:**  
3-point safety belt

## 6. Assembly of safety seats

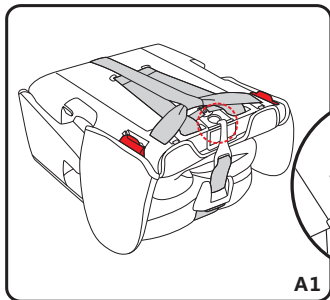

**Step 1:** Take the top tether from the backrest

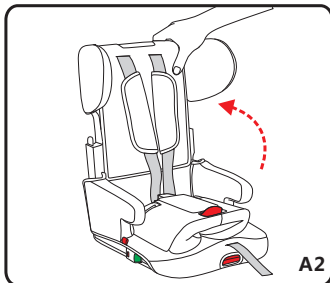

**Step 2:** Turn the backrest to vertical to the base(A1, A2).

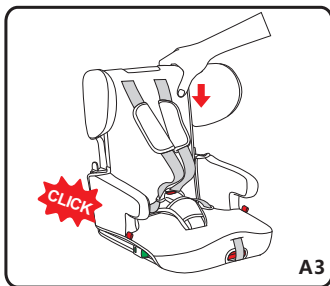

**Step 3:** Push the backrest down and press, when hear "click" it means well assembled.

**▲ Notice:** check and move the backrest to make sure it is firmly assembled.

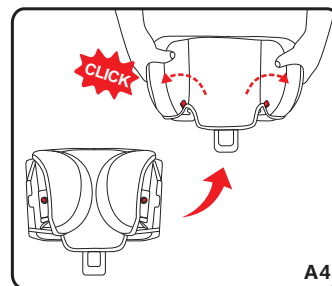

**Step 4:** Open two side pieces of headrest when here "click".

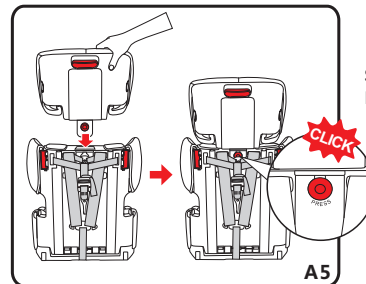

**Step 5:** Fix the headrest onto the backrest.

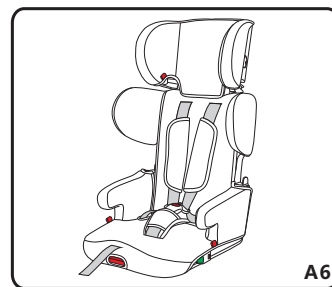

**Step 6:** Pull strap to tighten belts, baby car seat it ready for use.

## 7. Setting the shoulder belt height(group I)

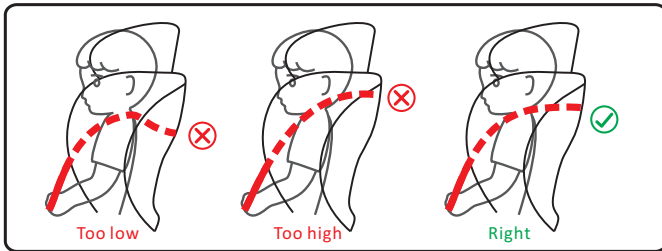

Check whether the shoulder belts are set at the right height for your child. The shoulder belts should be fed into the belt slots that lie at shoulder height or just above.

If the height of your shoulder belts in child car seat is not fit for your child, Adjust the height of the shoulder belts, please proceed as follows:

**Step 1.** Loosen the harness

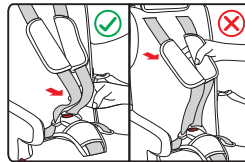
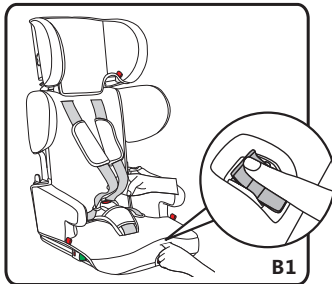

**Step 2:** Slide both of the harness straps off the harness connector.

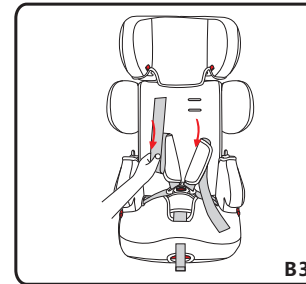
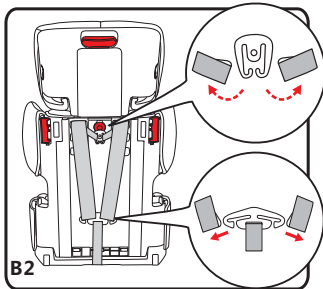

**Step 3:** Pull out the shoulder belt forward.

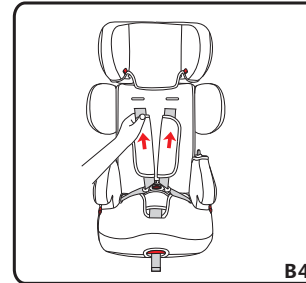

**Step 4:** Insert the harness into the suitable belt slot.

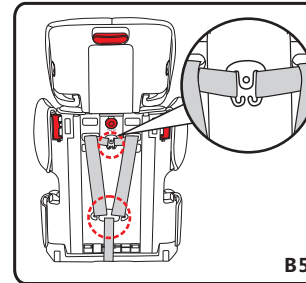

**Step 5:** Then re-thread the shoulder straps and chest straps into the appropriate strap slots from the front of the child seat and slide them in the harness connectors.

**Notice:** Ensure that the belt is positioned correctly in the belt slot and not twisted.

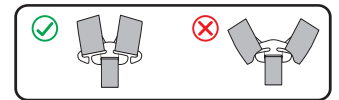

## 8.Height adjustment of headrest

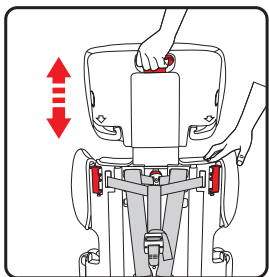

Pull the height adjuster to adjust the height of the headrest according to the child's height.

## 9. Using the buckle

### Locking Method

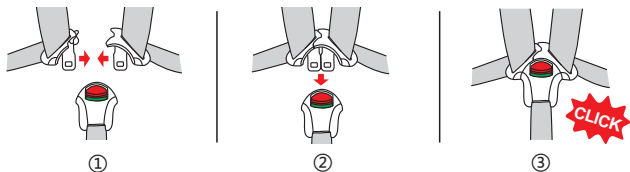

### Unlocking Method

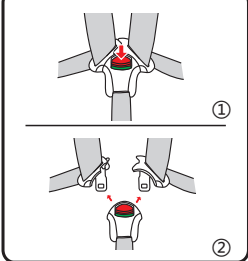

### Locking Method :

Align the left and right buckle tongues to one tongue and insert into the buckle until you hear a "Click" .

### Unlocking Method :

You can press the red button of the buckle downwards,the two metal sections will be pop up.

## 10. Installing the safety group I

It is suitable for the weight 9-18kgs, given to children about 9 months-4 years old.

**10.1 Instalation: isofix+top tether**  
**Securing the child: 5-point harness**



B1

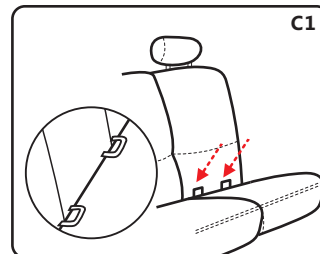

**Step 1:**Find out isofix connections in the car.

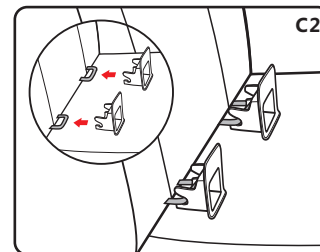

**Step 2:** Insert isofix guide into isofix connection

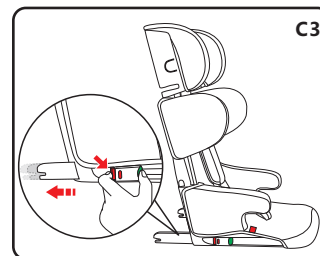

**Step 3:** Press both button and push out the isofix connector



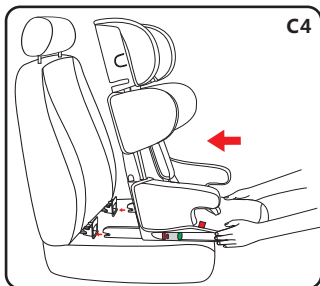

**Step 4:** Push child seat follow the direction and insert isofix connector into isofix guide(C4, C5) .

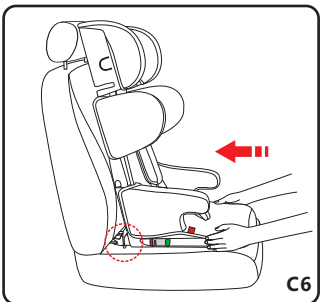
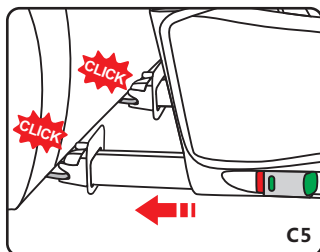

**Step 5:** Check if isofix locking system turns to green and make sure child seat is firmly connected.

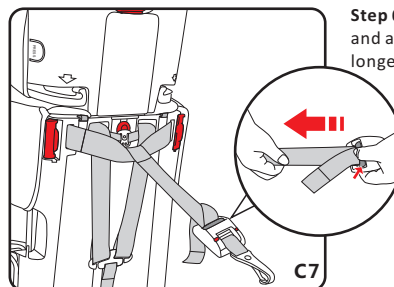
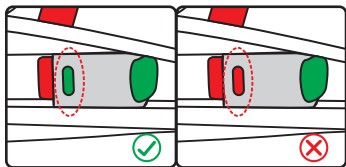

**Step 6:** Press the adjusting button and adjust the belt of top tether to the longest.

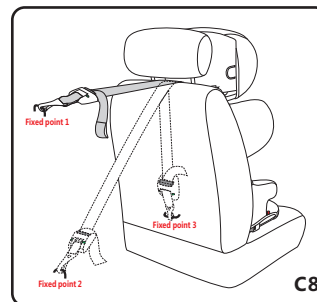

**Step 7:** Connect top tether with the fixing point on the car.

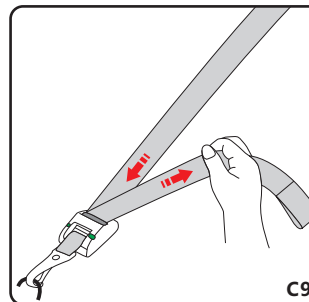

**Step 8:** String the belt of top tether until the adjuster shows green.  
**▲ Notice:** Top tether is only for group I

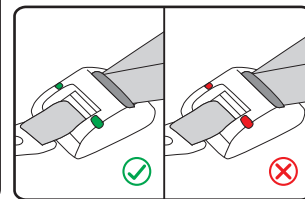

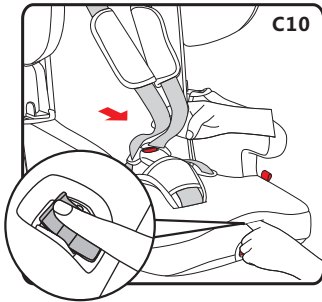

C10

Step 9: Loosen the harness

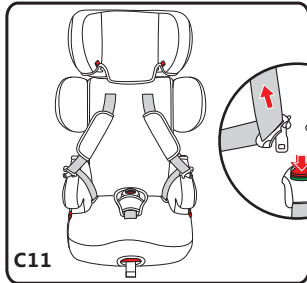
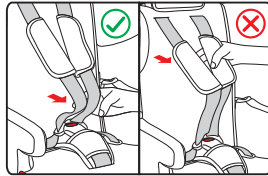

C11

Step 10: Release the buckle

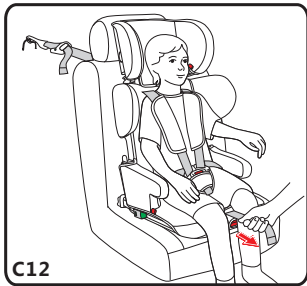

C12

Step 11: Put the child into the seat and fasten the harness. Check that the harness does not twisted.

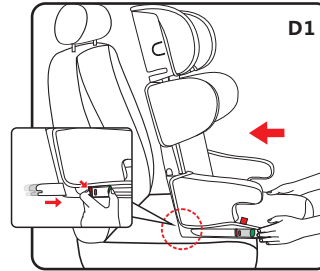

D1

**10.2 Installation: 3-point safety belt  
Securing the child: 5-point harness**

Step 1: Hide isofit in the booster.

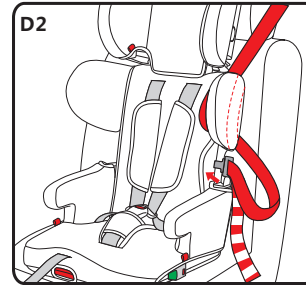

D2

Step 2: Put the seat against the car seat and use 3-point car seat belt to install.

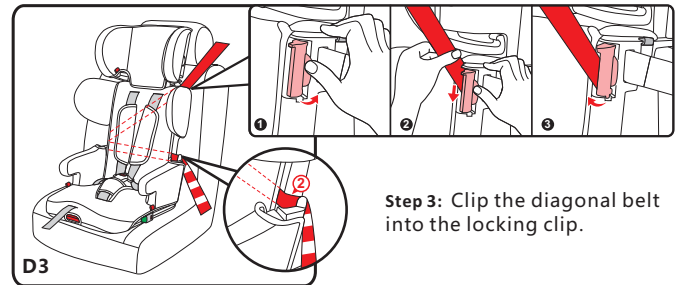

D3

Step 3: Clip the diagonal belt into the locking clip.

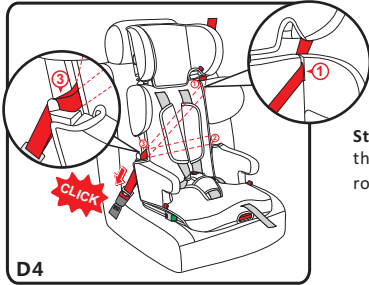

**Step 4:** Make car belt go through the front of seat and follow the routine ①②③(D3、D4).

D4

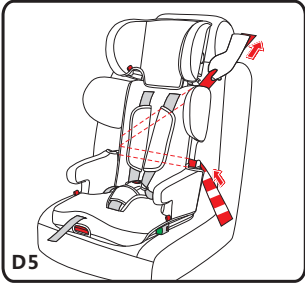

**Step 5 :** Fasten car seat belt and make sure, it is tight enough(D5).

D5

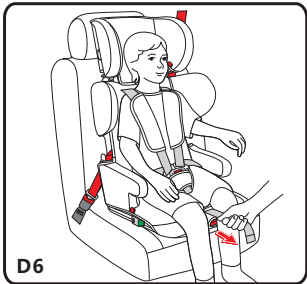

**Step 6:** Put the child into the seat and fasten the harness. Check that the harness does not twisted.

D6

## 11. Installing the safety group II, III

It is suitable for the weight 15-36kgs, given to children about 4 years-12 years old.

**Installation:** isofit installation as option

**Securing the child:** car seat belt

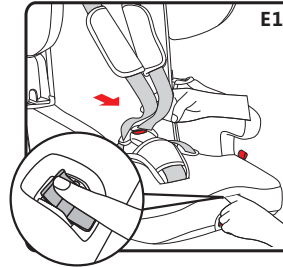

### 11.1 Remove the buckle and belt

**Step 1.** Loosen the harness

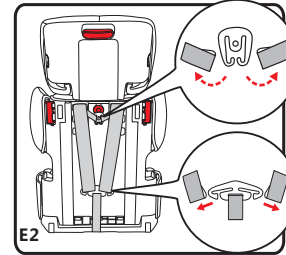
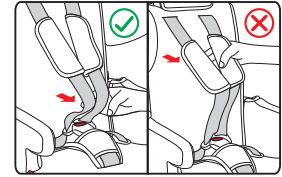

**Step 2:** Slide both of the harness straps off the harness connector.

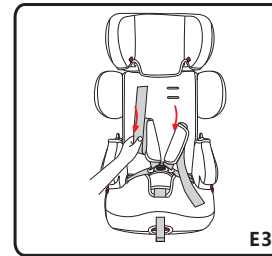

**Step 3:** Pull out the shoulder belt forward.

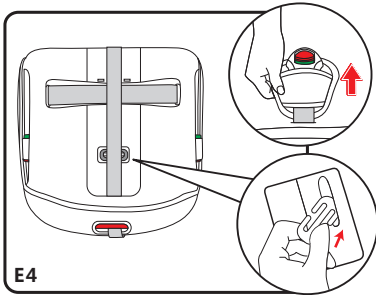

**Step 4:** Pull out the harness from the slot which under the safety car seat.

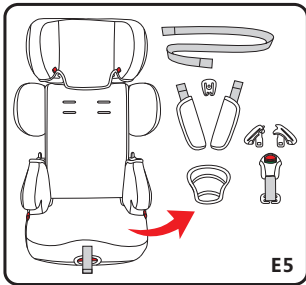

**Step 5:** Keep the removed cushion and accessories well.

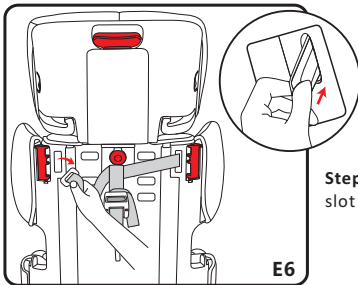

**Step 6:** Take out the bracket from the slot to take off top tether

## 11.2 Install the baby car seat

Group 2,3 installation can choose to use ISOFIT or not.

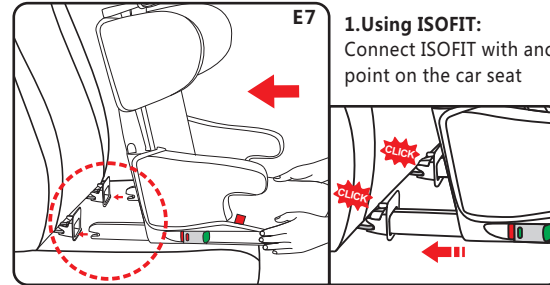

**1. Using ISOFIT:**  
Connect ISOFIT with anchorage point on the car seat

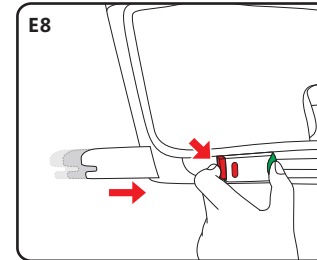

**2. Not using ISOFIT:**  
Hide ISOFIT in the booster. Put the seat against the car seat and use 3-point car seat belt to install. (E8, E9, E10, E11).

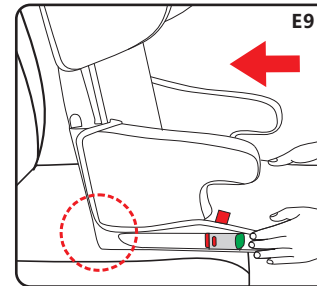

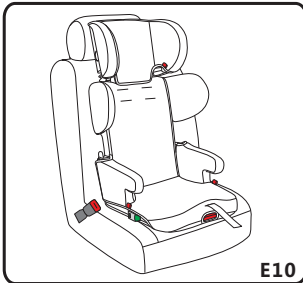

E10

### 11.3 Securing the child

**Step 1:** Follow the E11 routine to install the baby car seat.

**Notice:** Stock the baby car seat in a safe place or ensure the baby car seat is firmly installed when not using it.

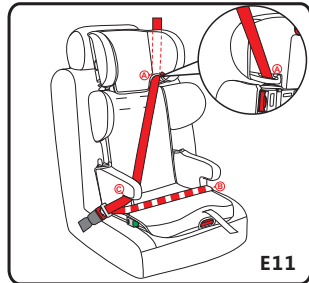

E11

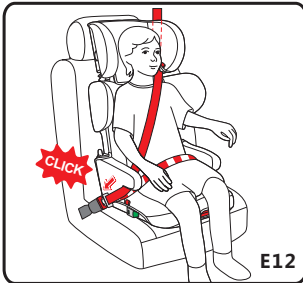

E12

**Step 2:** Put the child in the seat and follow E11 routine.

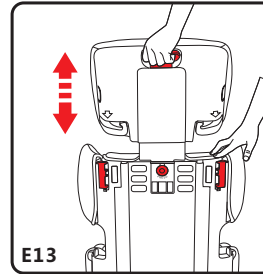

E13

**Step 3:** Use the height adjuster to adjust the height of the headrest according to the child's height. The gap between head belt guide and baby is 2 finger width. The harness straps should be level with or just above the child's shoulders (E13, E14).

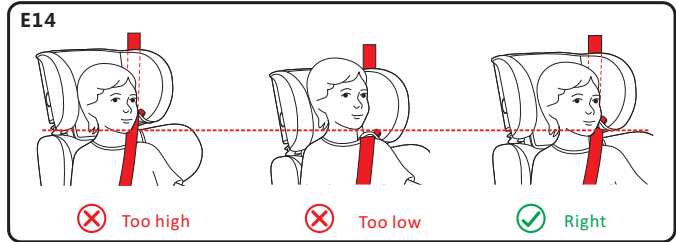

E14

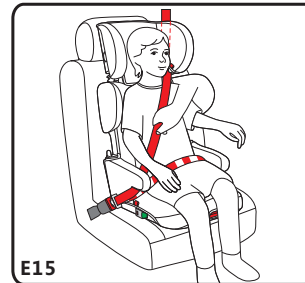

E15

**Step 4:** Fasten car seat belt and make sure, it is tight enough.

**Important:** Ensuring that any lap straps is worn low down, so that the pelvis is firmly engaged, shall be stressed.

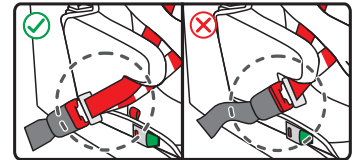

## 12. Unlock ISOFIX

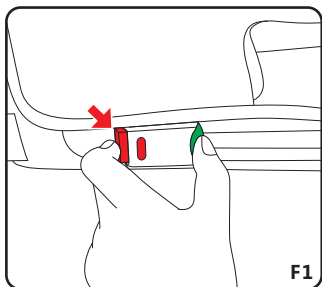

Press the red button to release the isofix connector and take away the seat

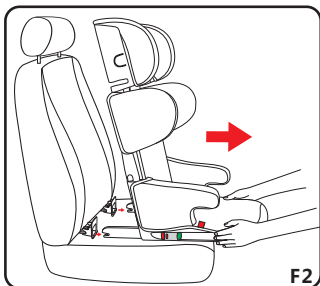

## 13. Folding way

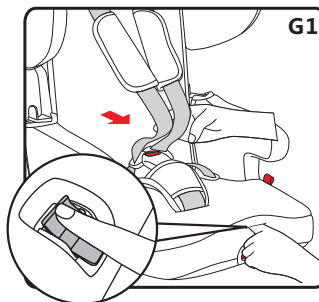

Step 1. Loosen the harness

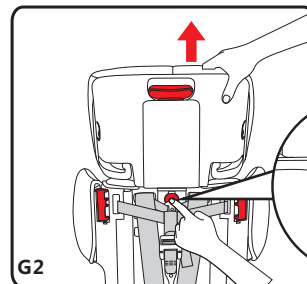
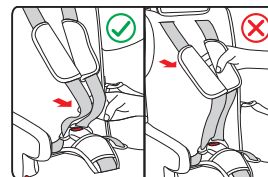

Step 2: Press the button on the back of headrest and take it off the backrest(G2)

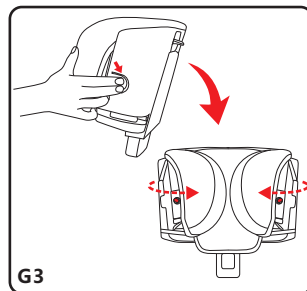

Step 3: Press the button on both outside of headrest and fold the headrest.

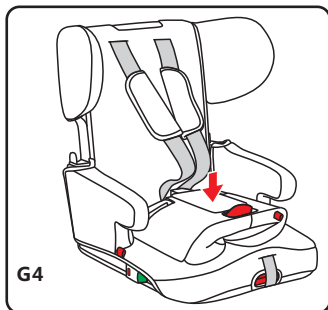

**Step 4:** Put headrest on the booster

G4

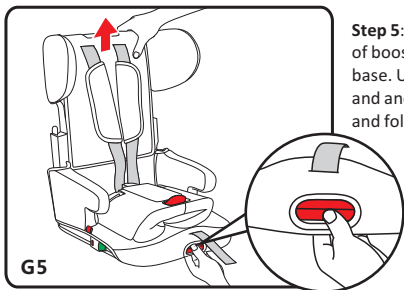

**Step 5:** Press the red button in the front of booster to separate the backrest from base. Use one hand to press the button and another hand pull upward the backrest and fold forward.

G5

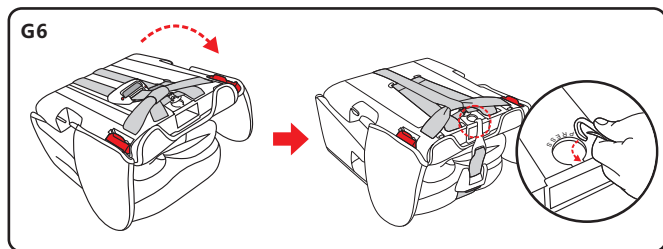

G6

## 14. Take off the fabric cover

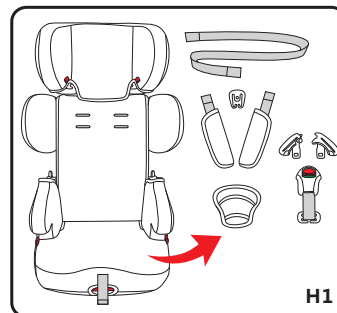

H1

**Step 1:** Follow the steps on page 19 and 20 to take off the accessories.

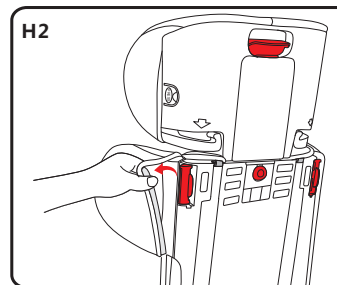

H2

**Step 2:** take out the backrest cover from the slot and take off

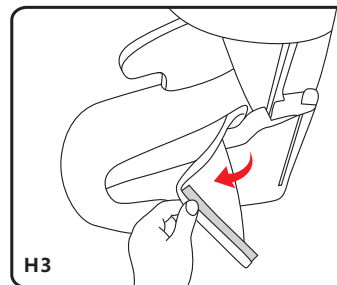

H3

**Step 3:** take out the booster cover from the slot and take off

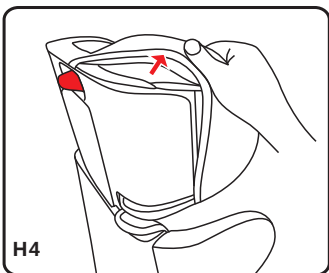

H4

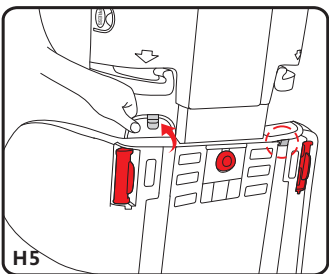

H5

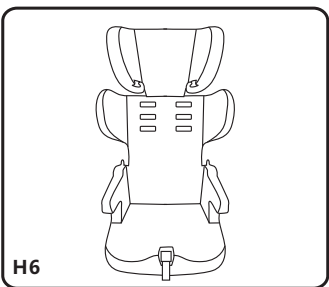

H6

**Step 4:** Take out the clips and take off the central piece of backrest cover

**Follow the steps in turn to put on the fabric cover.**

## 15. Maintenance and cleaning

### 15.1 Daily maintenance

1. In daily use, check periodically the child seat. The child seat should be replaced after an accident.
2. Please keep this child seat in dry and ventilated place to avoid damp moldy.
3. If the child seat becomes dusty, clean the seat belt and the plastic pieces by swiping them with a damp sponge and let it dry naturally.
4. If food or drink drop accidentally on the buckle, disassemble the seat belt from the child seat and rinse it gently by warm water. Leave it dry naturally.
5. For cleaning the entire child seat fabric cover, please refer to the 15.2 washing instructions.

### 15.2 Washing instruction

Never use any solvent, chemical detergent or lubricant on any part of your child seat.



Hand wash,  
water  
temperature  
below 30°C



Do not bleach



Dryclean, any  
solvent except  
trichloroethylene



Do not tumble dry



Do not iron

### 15.3 Remove and assemble the fabric cover

1. Firstly, remove the crotch pad and buckle of the child seat (see part 14), and then remove the shoulder straps and comfortable cushion.
2. Remove the fabric cover of the child seat. To install the fabric cover, please operate follow the above instructions in reverse order.



## 16. List of approved cars

The following vehicle list is only for reference. If your vehicle does not in the list, before using, please consult with the retailer or manufacturer.

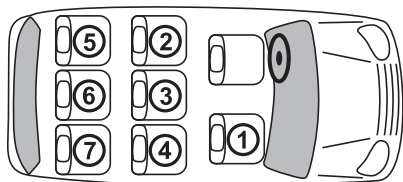

Saloon



Estate



Convertible



Hatchback



MPV



Coupe



No. of doors



No. of seat



Before you purchase the vehicle, check that it is equipped with the appropriate anchorages



Year of manufacture



Maximum body height















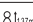















Approved seats

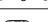
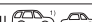

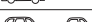

ALFA ROMEO		*	
156 Sportwagon / Crosswagon Q4	1997 2007		②④
159 Sportwagon	2005 2011	1.37m	②④
Giulietta 940	2010	1.37m	②④
GT Sportcoupe	2004 2010	1.37m	②④
MiTo	2008	1.37m	①②④
BMW		*	
1(E87/E82/E81)  3+5	2005		②④
1(E82)	2007		②④
1(E88)	2008		①②④
3(E90)	2005		②④
3(E92)	2005		②④
3	08/05		②④
5(F10)	2010		②④
5(F11) Touring	2010		②④
5 GT	10/09		②④
7(E65) (Facelift 2005)	2001 2008		②④
7(F01)	2008		②④
Mini Club Man	2007		②④
Mini Countryman  4	2010		②④
Mini Countryman  5	2010		④
X1	10/09		②④
X5	2006		②④
X6	2008	1.35m	②④
Z4	2002	ISOFIX	①
DACIA		*	
Duster	2010		②④
Lodgy	2012		②③④

Logan	2004		②④
Sandero	2008		②④
Sandero Stepway	2009		②④
Sandero Live 2	2012		②④
FORD		*	
B-MAX	2012		②④
C-MAX	2011		②④
C-MAX	2003 2010		②④
Fiesta(MK7)  3+5	2008	1.37m	②④
Fiesta	2012	1.37m	②④
Focus	2011		②④
Focus	2004 2010	1.37m	②④
Focus Turnier	2008 2010		②④
Kuga	2013		②④
Mondeo Turnier	2007		②④
Ranger	2011		②④
S-Max(Facelift 2010)	2006		②③④
Tourneo Connect	2002 2013		②④
Transit Custom	2012		②③⑥
HYUNDAI		*	
Accent  3+5	2000 2005		②④
Coupe	1999 2002		②④
Elantra  5	2000 2006		②④
Getz	2002 2009		②④
H 1	2007		②④
i 10	2008		②④
i 20	2008		②④
ix20	2010		②④

i 30 	2007 2012	② ④
i 35	2009	② ④
i 40	2011	② ④
Matrix	2001 2010	② ④
<b>KIA *</b>		
Carens	2006 2013	② ④
Carnival	2005	② ④ ⑤ ⑦
Ceed 	2006 2012	② ④
Ceed 	2012	② ④
Cerato	2004 2008	② ④
Opirus	2003 2010	② ④
Magentis	2001 2005	② ④
Picanto	2004 2011	② ④
Rio	2005 2011	② ④
Rio	2011	② ④
Soul	2008	② ④
<b>LEXUS *</b>		
GS	1997 2005	 ① ③ ⑦ ② ④
IS	1998 2005	 ① ③ ⑦ ② ④
IS	2005 2013	 ① ③ ⑦ ② ④
RX	2003 2009	② ④
<b>MAZDA *</b>		
2 DY	2003 2007	② ④
2 DE	2007	② ④
2	2013	② ④
3 BL	2003 2009	② ④

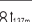
3 BK	2009 2013	② ④
5 	7 2005 2010	② ④
5 CW	2010	② ④
6 	2002 2007	 ① ③ ⑦ ② ④
6 	2008 2012	 ① ③ ⑦ ② ④
CX 7	2006 2009	② ④
CX 7	2009	② ④
MX5 	5 1998 2005	①
MPV 	6+7 1999 2005	
Premacy	1999 2005	② ④
RX 8	2003 2012	② ④
<b>MERCEDES-BENZ *</b>		
A	05/05	② ④
B (Facelift 2008)	06/05	② ④
C (Facelift 2004) 	2000 2007	② ④
C (W204) 	2007	② ④
C (S204) 	2007	② ④
C (204)	03/11	② ④
E (W212; S212) 	2009	② ④
E (C207) 	2009	② ④
GLK	2008	② ④
ML (W164)	07/05	② ④
R (W251/V251)	12/05	② ④ ⑤ ⑦
<b>SKODA *</b>		
Citigo	2011	 ① ③ ⑦ ② ④
Fabia I 	1999 2007	② ④

Fabia I 	1999 2007	② ④
Fabia II 	2007	② ④
Felicia 	1994 2001	② ④
Octavia I 	2000 2010	① ② ④
Octavia II 	2004 2012	① ② ④
Octavia III 	2013	① ② ④
Octavia Scout 	2007 2012	② ④
Rapid	2012	② ④
Roomster(+Facelift)	2006	② ④
Superb I	2001 2008	② ④
Superb II 	2008	② ④
Yeti	2009	② ④
<b>SUBARU *</b>		
Forester	2008 2013	② ④
Impreza 	2007 2012	② ④
Legacy 	2003 2009	② ④
Outback	2003 2009	② ④
Outback	2009	② ④
Trezia	2011	② ④
<b>TOYOTA *</b>		
Auris	2007 2012	② ④
Auris Hybrid	2010	② ④
Avensis(T25) 	2003 2009	② ④
Avensis(T27) 	2009	② ④
Corolla 	1997 2002	② ④
Corolla 	2002 2009	② ④
Corolla 	2006	② ④

IQ	2009	② ④
Land Cruiser	2002 2009	② ④
Land Cruiser	2009	② ④
Previa/Estima	2000 2006	② ④
Previa/Estima	2006	② ④
Prius	2003 2009	② ④
Prius(+Facelift)	2009	② ④
RAV 4	2000 2006	② ④
RAV 4	2006 2013	② ④
Urban Cruiser	2009	② ④
<b>VOLVO *</b>		
C 30	2006 2012	 ① ③ ⑦ ② ④
C 70	2005 2013	② ④
XC 70	2003	② ④
S 40/V 40	1995 2004	② ④
S 40/V 40	2004 2012	② ④
S 60	2000 2009	② ④
S 60	2010	② ④
S 80	1998 2006	② ④
S 80 (+Facelift )	2006	② ④
V 50	2004 2007	② ④
V 50	2007 2012	② ④
V 60	2010	 ① ③ ⑦ ② ④
V 70 	2000 2007	② ④
V 70  /XC70 (+Facelift)	2007	② ④
XC 60	2008	② ④