

INSTRUCTION FOR USE

Congratulations on your purchase of the child seat. Please read this instruction manual carefully before use. If you have any questions concerning the use of this child seat, please do not hesitate to contact us.

CHILD RESTRAINT LM315



GROUP 0+, I, II, III
SUITABLE FOR CHILDREN
LESS THAN 36 KG

⚠ WARNING: DO NOT place rear-facing child seat on front seat with airbag. DEATH OR SERIOUS INJURY can occur.

Contents

1. Vital information-READ NOW.....	2-3
2.Safety instruction.....	4
3.Using safety seat in this way.....	4
4.Parts and interior equipment.....	5
5.Scope of application for children.....	6
6.Using the buckle.....	7
7.Using the belt lock-off.....	7
8.Adjust the harness.....	8
9.Adjust the backrest angle.....	8
10.Adjust the height of the shoulder harness and the headrest.....	9
11. Instructions for use of cushion.....	9
12.Installation of the child seat group 0+.....	10-11
13.Installation of the child seat group I.....	12-13
14.Installation of the child seat group II,III.....	14-15
15.Remove the cover.....	16-18
16.Maintenance and cleaning.....	18

NOTICE

1. This is a “Universal” child restraint, it is approved to Regulation NO.44.04 series of amendments, for general use in vehicles and it will fit most, but not all, car seats.
2. A correct fit is likely if the vehicle manufacturer has declared in the vehicle handbook that the vehicle is capable of accepting a “Universal” child restraint for this age group.
3. This child restraint has been classified as “Universal” under more stringent conditions than those which applied to earlier designs which do not carry this notice.
4. If in doubt, consult either the child restraint manufacturer or the retailer.

Only suitable if the vehicle is fitted with 3-point safety belts, Approved to UN/ECE Regulation No.16 or other equivalent standards.

1. Vital information-READ NOW

For your child’s safety, please read these instructions carefully before use and keep them for future reference. Failure to follow the instructions contained in this manual could result in serious injury to your child.

1. This child seat can only be used with the harness for children less than 18 kg in weight (group 0+, I less than 18kg).
2. This child seat can be installed rearward-facing and forward-facing using a three-point lap and diagonal seat belt. Important-Do not use forward-facing before the child’s weight exceeds 9 kg.
3. This instruction manual can be retained in the special space of the child seat for its life period.
4. Do not use this child seat in the home. It has not been designed for home use and should only be used in your car.
5. It shall be recommended that children are not left in their child restraint system unattended.
6. Do not place rear-facing child seat on front seat with airbag. Death or serious injury can occur.
7. The child seat should be changed when it has been subject to violent stresses in an accident.
8. For the reason of safety, the child seat must be fixed inside the vehicle even if you do not put your child inside the child seat.
9. Always make sure that any straps holding the seat restraint to the vehicle shall be tight, any straps restraining the child should be adjusted to the child’s body, and check that the straps shall not be twisted.

10. Ensuring that any lap straps is worn low down, so that the pelvis is firmly engaged, shall be stressed.
11. Do not use any load bearing contact points other than those described in the instructions and marked in the child restraint.
12. Any luggage or other objects liable to cause injuries in the event of a collision shall be properly secured.
13. The rigid items and plastic parts of a child restraint must be so located and installed that they are not liable, during everyday use of the vehicle to become trapped by a moveable seat or in a door of the vehicle.
14. To prevent from the risk of fall, your child should always be fastened.
15. It is dangerous to make any alteration or additions to the device without the approval of the competent authority, and a danger of not following closely the installation instructions provided by the child restraint manufacturer.
16. This child seat is designed for children from birth up to 36 kg. Never overload the child seat more than one child or with other loads.
17. The child restraint must not be used without the cover.
18. The seat cover should not be replaced with any other than the one recommended by the manufacturer, because the cover constitutes an integral part of the restraint performance.
19. Before you adjust any movable or adjustable parts of your child seat, you must remove your baby from the child seat.
20. The child seat should be kept away from sunlight if the seat is not provided with a textile, otherwise it may be too hot for the child's skin.
21. Never use a second-hand product, as you can never be certain what was happened to it.

2. Safety instruction

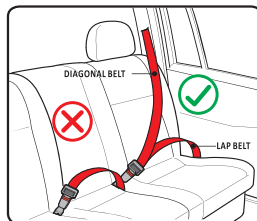

Only suitable if the approved vehicles are fitted with 3 point safety-belts, approved to UN/ECE Regulation No.16 or other equivalent standards.



NOTICE: If the buckle strap of car seat is too long, the child restraint system can not be installed firmly. It is very dangerous. If any doubt, please consult the child restraint system manufacturer.

3. Using safety seat in this way

Forward facing traffic direction	Correct
Back facing traffic direction	Error
Vehicle is only fitted with 2-point safety belt	Error
Vehicle is fitted with 3-point safety belt	Correct
Seat beside the driver	Error
Rear seat	Correct
Rear middle seats Three-point Belt	Correct

3.1 Please carefully implement the Country Traffic Safety Regulations

- Do not install the child safety seat at the front seat with airbag.
- Please read the instruction manual carefully that how to use the airbag.

NOTICE

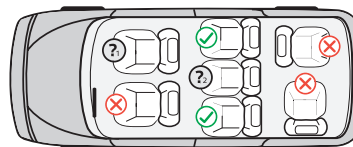

- ✓ You can install this position
- ✗ Unable to install the position
- ❓ Do not install the child safety seat at the front seat with air bag.
- ❓ Only with the three point safety belt, can this location.

4. Parts and interior equipment

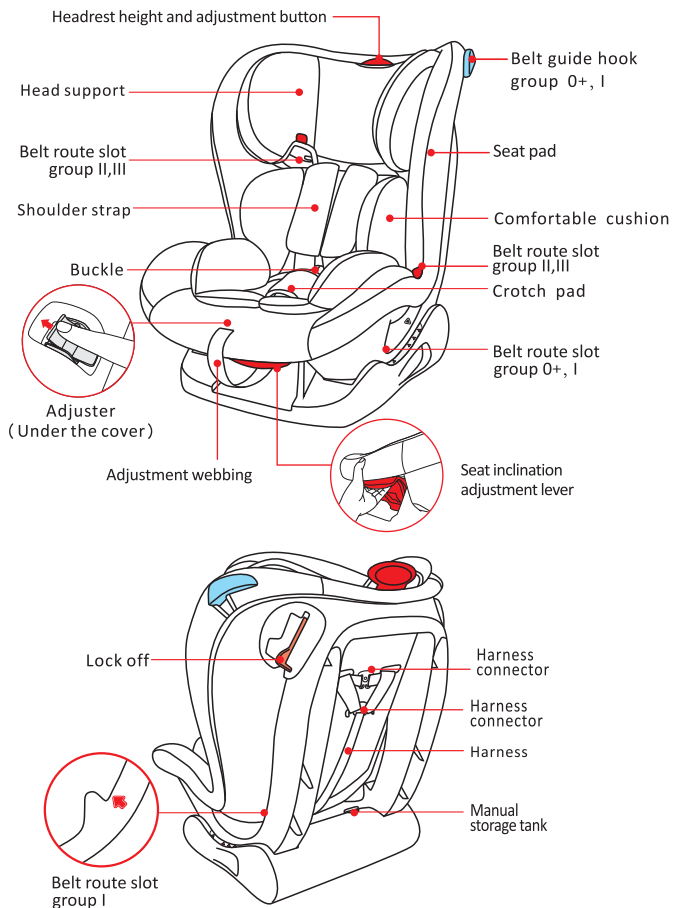

5. Scope of application for children

GROUP 0+,I REARWARD FACING

It is suitable for the weight 0-18 kgs, given to children about 0-4years old.

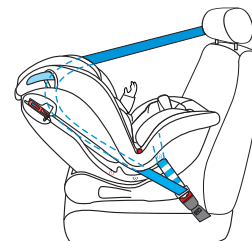

Installation :
3-point safety belt
Securing the child:
5-point harness

GROUP I Forward facing

It is suitable for the weight 9-18 kgs, given to children about 9 months-4 years old.



Installation :
3-point safety belt
Securing the child:
5-point harness

GROUP II,III Forward facing

It is suitable for the weight 15-36 kgs, given to children about 4-12 years old.



Installation :
3-point safety belt
Securing the child:
3-point safety belt

6. Using the buckle

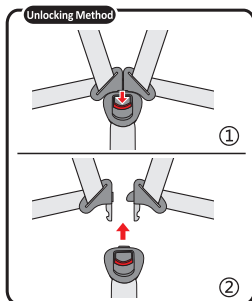
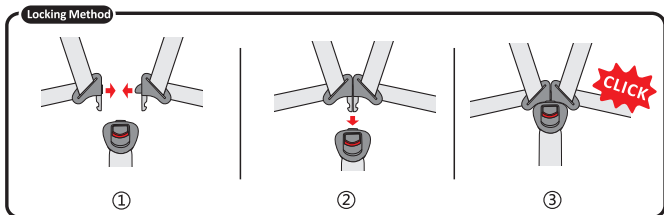

Locking Method :

Align the left and right buckle tongues to one tongue and insert into the buckle until you hear a "Click" .

Unlocking Method :

You can press the red button of the buckle downwards, the two metal sections will be pop up.

7. Using the belt lock-off

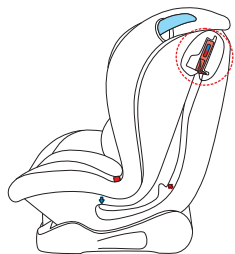

Open the red belt lock-off, pull the diagonal belt into the belt red lock-off and then lock it.



STEP 1



STEP 3

8. Adjust the harness

-Loosening the shoulder harness

Press the adjuster button under the cover and at the same time pull both shoulder straps forward.

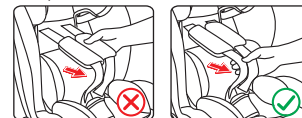
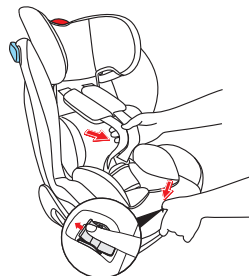

-Tightening the shoulder harness

Pull the adjuster strap until the harness is fully tightened.



9. Adjust the backrest angle

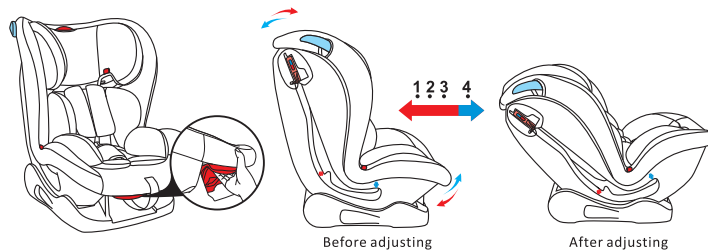

The child seat can be adjusted to 4 different positions. **If installed rearward-facing (group 0+), only the position 4 can be used.** Pull the positioning handle under the front of the seat upwards, and then pull or push the seat forwards or backwards. Release the positioning handle in the desired position and push until you hear a "click".

Important: Check to make sure the child seat is securely locked in the desired position by pulling the positioning handle.

10. Adjust the height of the shoulder harness and the headrest

Always check that the shoulder straps are at the correct height for your child.

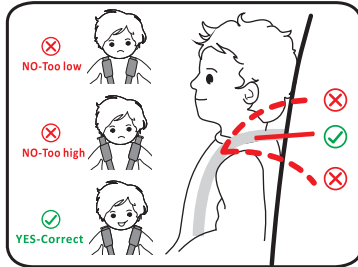
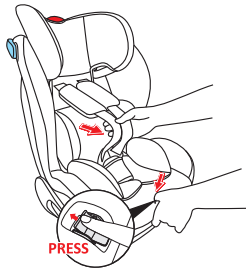

Step 1: Press the adjuster button under the cover and at the same time pull both shoulder straps forward.

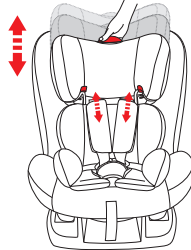

Step 2: Pull the height adjuster to adjust the height of the harness and the headrest according to the child's height.

Note! The height for the harness is adjusted by lifting the headrest.

11. Instructions for use of cushion

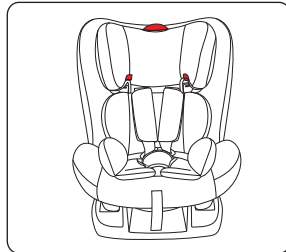
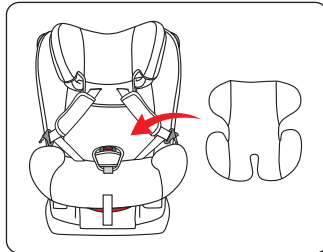

NOTICE: Please use cushion for the child less than 15kgs
Put cushion in child restraint system, and then adjust harness and cushion following the picture

12. Installation of the child seat group 0+, I

It is suitable for the weight 0-18 kg, given to children about 0-4 years old.

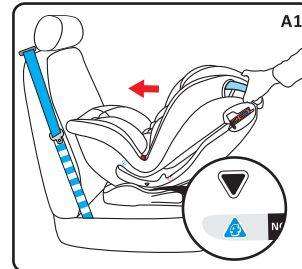

Step 1: Adjust the child seat to position 4. Place the child seat on the car seat rearward-facing and make sure that the front of the child seat is firmly pressed against the car seat backrest (A1).

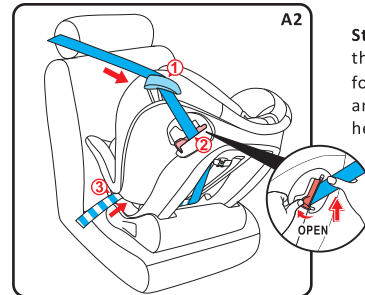

Step 2: Pull out the 3-point car seat belt, through the belt route slot of backrest follow the routine ①②③④ (A2, A3), and then insert into car seat belt buckle, hear "click".

Step 3: Pull car seat belt follow the direction of red arrow and make sure the belt is tight enough (A4).

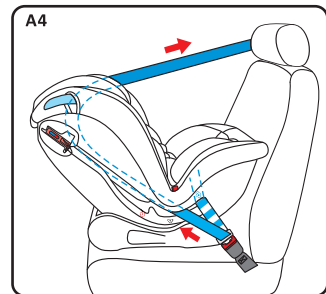
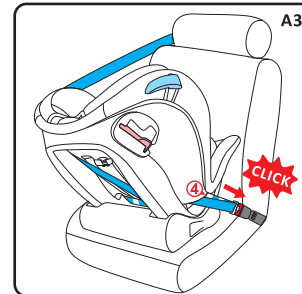

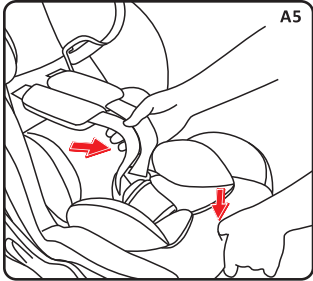

Step 4: Loosening the shoulder harness

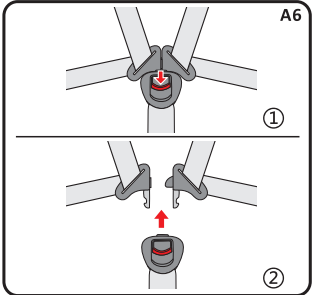

Step 5: Release the buckle

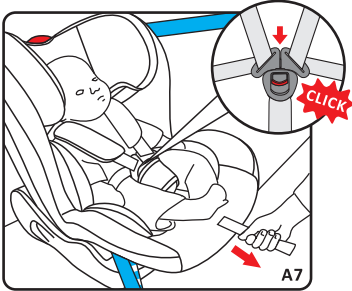

Step 6: Put the child into the seat and fasten the harness. Check that the harness does not twisted.

13. Installation of the child seat group I

It is suitable for the weight 9-18 kg, given to children about 9 months-4 years old.

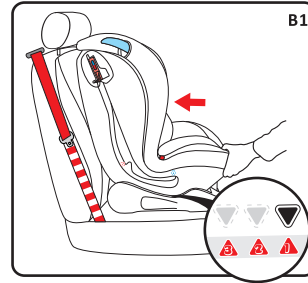

Step 1: Adjust the seat to the right position, place it on the car seat forward-facing and make sure the backrest of seat is firmly pressed against the backrest of car seat(B1).

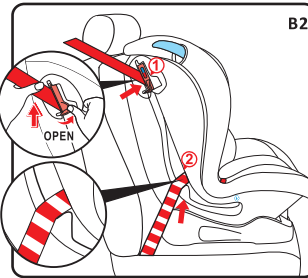

Step 2: Pull out the 3-point car seat belt, through the belt route slot of backrest follow the routine ①②③(B2、B3)and then insert into car seat belt buckle, hear“click”.

Step 3: Pull car seat belt follow the direction of red arrow and make sure the belt is tight enough(B4).

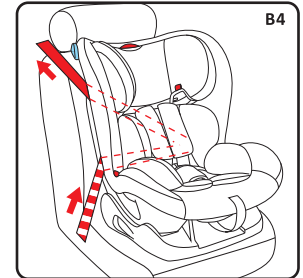
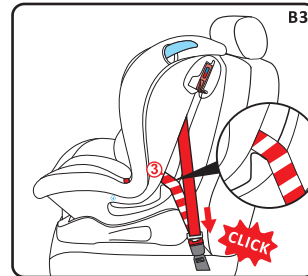

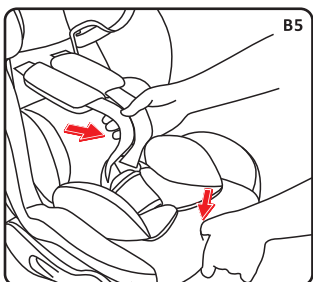

Step 4: Loosening the shoulder harness(B5)

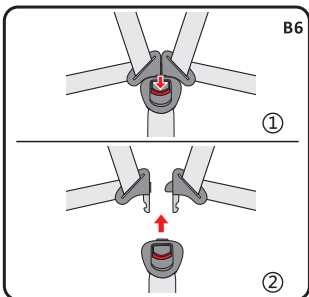

Step 5: Release the buckle(B6)

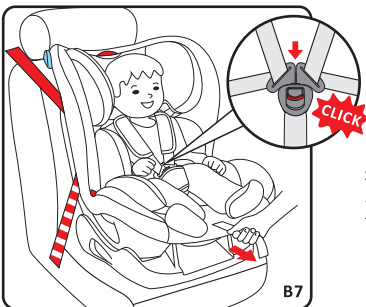

Step 6: Put the child into the seat and fasten the harness. Check that the harness does not twisted.

14. Installation of the child seat group II,III

It is suitable for the weight 15-36 kg, given to children about 4-12 years old.

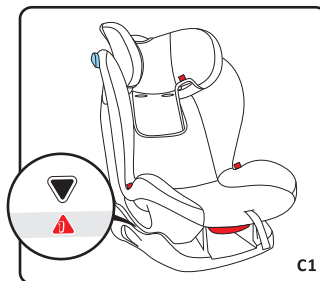

Step 1: Refer to the picture D1 to D7 of page 16 to 18, take off the cushion and harness, and adjust the seat to recline position 1 (C1)

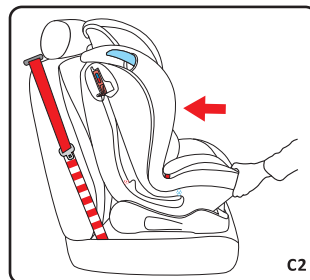

Step 2: Put the seat against the car seat (C2)



Step 3: Put the child in the seat and follow C3, C4, C5 routine to install.



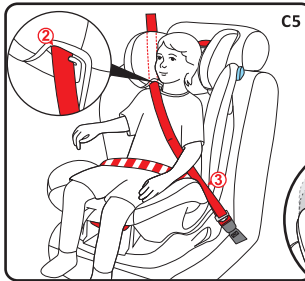

C5

Step 4: Use the height adjuster to adjust the height of the headrest according to the child's height. The gap between head belt guide and baby is 2 finger width. The harness straps should be level with or just above the child's shoulders (C5, C6).

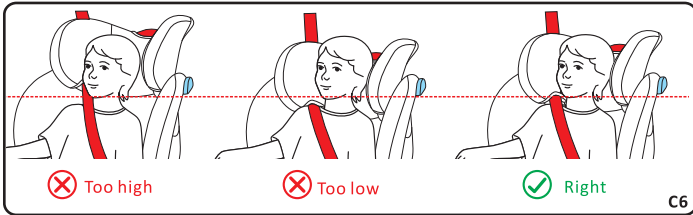
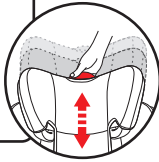

C6

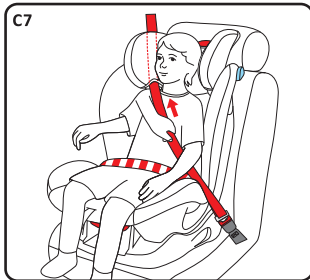

C7

Step 5: Fasten car seat belt and make sure, it is tight enough.

15. Remove the cover

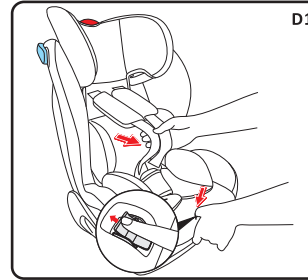

D1

Step 1. Loosen the harness (D1)

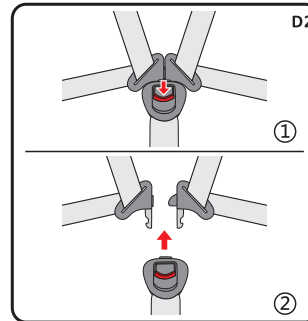

D2

Step 2: Release the buckle (D2)

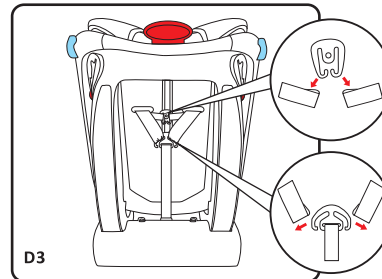

D3

Step 3: Slide both of the harness straps off the harness connector (D3).

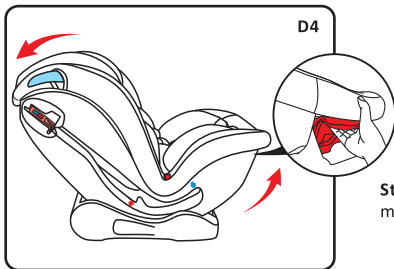

Step 4: Adjust the child seat to the maximum angle

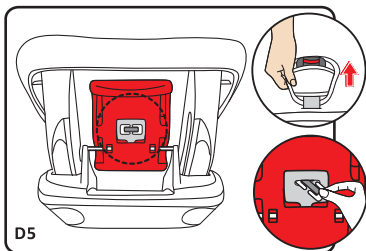

Step 5: Turn it to the bottom. Turn the harness locking clip on their narrowest end and thread it through the slot under the bottom of the child seat. So the crotch pad and buckle as well as harness straps can be removed (D5).

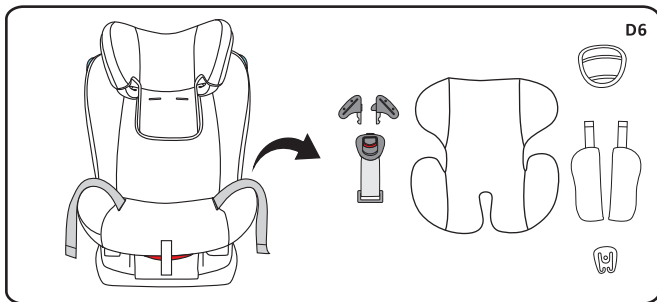

Step 6: Keep the removed cushion and accessories well.

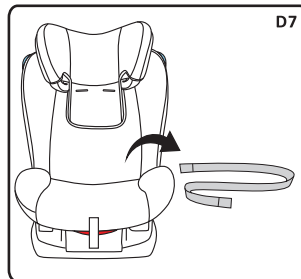

Step 7: Remove the harness

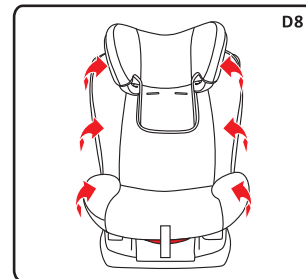

Step 8: Pull all directions to take out the cover(D8).

✘ Follow in reverse order and repeat the procedure to put on the fabric cover

16. Maintenance and cleaning

16.1 Daily maintenance

1. In daily use, check periodically the child seat. The child seat should be replaced after an accident.
2. Please keep this child seat in dry and ventilated place to avoid damp moldy.
3. If the child seat becomes dusty, clean the seat belt and the plastic pieces by swiping them with a damp sponge and let it dry naturally.
4. If food or drink drop accidentally on the buckle, disassemble the seat belt from the child seat and rinse it gently by warm water. Leave it dry naturally.
5. For cleaning the entire child seat fabric cover, please refer to the 16.2 washing instructions.

16.2 Washing instruction

Never use any solvent, chemical detergent or lubricant on any part of your child seat.

