

# INSTRUCTIONS FOR USE

## CHILD RESTRAINT LM203 GROUP I,II,III

SUITABLE FOR CHILDREN  
FROM 9 TO 36 KG

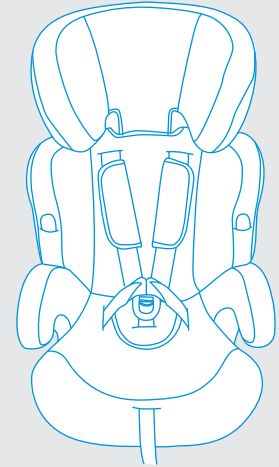

## NOTICE

1. This is a "Universal" child restraint, it is approved to Regulation NO.44.04 series of amendments, for general use in vehicles and it will fit most, but not all, car seats.
2. A correct fit is likely if the vehicle manufacturer has declared in the vehicle handbook that the vehicle is capable of accepting a "Universal" child restraint for this age group.
3. This child restraint has been classified as "Universal" under more stringent conditions than those which applied to earlier designs which do not carry this notice.
4. If in doubt, consult either the child restraint manufacturer or the retailer.

Only suitable if the vehicle is fitted with 3-point safety belts. Approved to UN/ECE Regulation No. 16 or other equivalent standards.

## Contents

1. Vital information-READ NOW.....	1-2
2. Applicability.....	3
3. Safety instruction.....	3
4. Using safety seat in this way.....	4
5. Parts and interior equipment.....	5
6. Installing the safety group I.....	6-10
7. Installing the safety group II with backrest.....	10-12
8. Installing the seat(group II+III without backrest).....	12-13
9. How to dispose.....	13
10. Washing instructions.....	14

### 1. Vital information-READ NOW

1. The customer can write to the address printed on the box to obtain future information on fitting the child restraint in specific cars.
2. The rigid items and plastic parts of a child restraint must be so located and installed that they are not liable, during everyday use of the vehicle to become trapped by a movable seat or in a door of the vehicle.
3. Any straps holding the restraint to the vehicle should be tight; that any straps restraining the child should be adjusted to the child's body; and that straps should not be twisted.
4. The instructions can be retained on the child restraint for its life period.

5. Do not use any load bearing contact points other than those described in the instructions and marked in the child restraint.
6. Any lap strap is worn low down, and the pelvis must be firmly engaged shall be stressed.
7. The device should be changed when it has been subject to violent stresses in an accident.
8. It is dangerous to make any alterations or additions to the device without the approval of the competent authority, and a danger of not following closely the installation instructions provided by the child restraint manufacturer.
9. When the chair is not provided with a textile cover, it should be kept away from sunlight, otherwise it may be too hot for the child's skin.
10. Children must not be left in their child restraint system unattended.
11. Any luggage or other objects liable to cause injuries in the event of a collision shall be properly secured.
12. The child restraint must not be used without the cover.
13. The seat cover can not be replaced with any other than the one recommended by the manufacturer, because the cover constitutes an integral part of the restraint performance.

## 2. Applicability

The child car seat is suitable for weight categories I to III (Group I-III), which means children with a body weight between 9kg and 36kg

Mass **Group I: 9kg-18kg**

Mass **Group II: 15kg-25kg**

Mass **Group III: 22kg-36kg**

This child car seat can be used with its harness system for children of weight group I. It must be secured with the belt fastener on the 3-point vehicle belt.

For children of weight categories II and III (15kg to 36kg) the harness system must be removed and the vehicle's 3-point belt system used to secure the child.

## 3. Safety instruction

Only suitable if the approved vehicles are fitted with 3-point safety-belts, approved to UN/ECE Regulation No.16 or other equivalent standards.

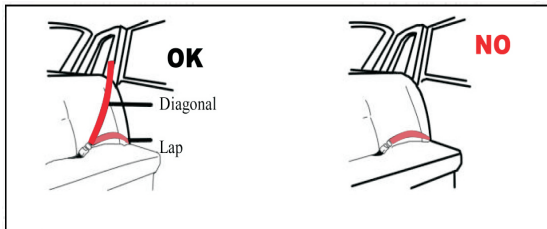

## 4. Using safety seat in this way

Forward facing traffic direction	Correct
Back facing traffic direction	Error
Vehicle is only fitted with 2-point safety belt	Error
Vehicle is fitted with 3-point safety belt	Correct
Seat beside the driver	Error
Rear seat	Correct
Rear middle seats Three-point Belt	Correct

### 4.1 Please carefully implement the Country Traffic Safety Regulations

- Do not install the child safety seat at the front seat with air bag.
- Please read the instruction manual carefully that how to use the airbag.

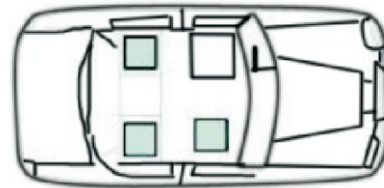

## 5. Parts and interior equipment

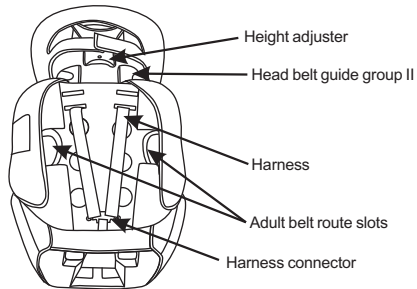
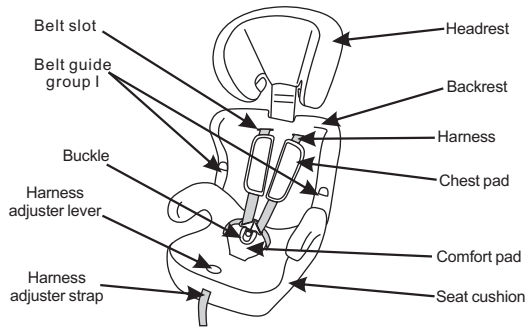

## 6. Installing the safety group I

Use of the harness system is only permitted for children of age group I which means from 9kg to 18kg.

### 6.1 Setting the shoulder belt height(group I)

Check whether the shoulder belts are set at the right height for your child. The shoulder belts should be fed into the belt slots that lie at shoulder height or just above.



If the height of your shoulder belts in child car seat is not fit for your child. Adjust the height of the shoulder belts, please proceed as follows:

Step 1: Loosen the harness (see point 6.3), turn the child seat to the back.

Step 2: Slide both of the harness off the harness connector (Fig. 2)

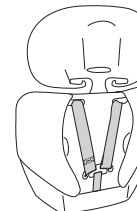

Fig. 1

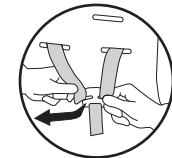

Fig. 2



Fig. 4



Fig. 5

**Step 4:** Now you can pull both chest pads and shoulder belts forward through the belt slots carefully(fig.4).

**Step 5:** Now thread the small belts of the chest pads and harness into the corresponding belt slots. (fig.5)

**Step 6:** Slide both of the chest pads in the chest pad connector, and slide the harness straps in the harness connector.

Ensure that the belt is positioned correctly in the belt slot and not twisted.

### 6.2 Securing the child car seat(group I)

**Step 1:** Place the child safety seat on the vehicle's seat which is fitted with 3-point safety belts ensuring it is firmly pressed against the car seat backrest(Fig.1)

**Step 2:** Pull out the vehicle belt, Thread the belt tongue(include vehicle belt)through the Adult belt route slot to the rear and through the backrest,through the other adult belt route slot(on the buckle side).and allow it to lock in place. You will hear "click"(Fig.1).

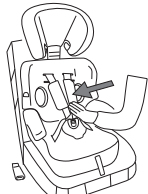

Fig. 1

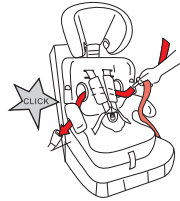

Fig. 2

**Step 3:** Place the vehicle lap belt under the arm rest. Note: Pull the vehicle diagonal belt on the vehicle buckle side and then pull the vehicle diagonal belt together with the vehicle lap belt under the arm rest.

**Step 4:** Press your knee on the child car seat and pull the diagonal belt along the direction as the picture shows(fig.4). Make sure that belt has not loosened. Tighten the diagonal sh-oulder belt in the direction of the automatic roll-up as possible.

The satisfactory position of the adult safety-belt buckle relative to the child car seat is as the Fig 6. You can contact the child car seat manufacturer if in doubt about this point.

To release your child seat following the above instructions in reverse order.

Ensure that each part of the belt is tightened as possible.

Make sure all the belt position is right and they has not become twisted. Also check that the cover is not impeding the movement or fit of the belt webbing in any way.

When installing the child car seat(Group I), In no way should you use the head belt guide(group II) in the headrest.

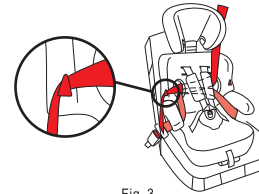

Fig. 3



Fig. 4

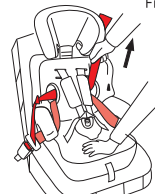

Fig. 5

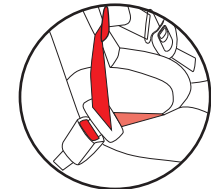

Fig. 6

### 6.3 Loosening the harness

- The harness is slackened by pressing the lever (under the seat cover) on the front of the seat.
- Press down on the label marked "Press" as you grip the two shoulder straps with your other hand. Pull the shoulder straps towards you to loosen the harness. (see the picture on the right)



### 6.4 Securing the child with the harness

- Firstly, adjust the shoulder belts height (see point 6.1), proceed as follows:
- Loosen the harness (see point 6.3), open the buckle (6.4.1), and place them down sideways.
- Seat your child in the child car seat. Place both shoulder belts over your child's shoulders.
- Fasten the buckle (6.4.1).
- Pull the shoulder straps upwards to remove the slack from the lap sections of the harness then pull the adjuster strap until the harness is fully tightened
- The harness should be adjusted as tightly as

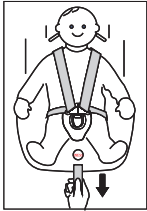

possible without causing discomfort to your child.

- A loose harness can be dangerous. Check the harness adjustment and tighten each time the child is placed in the seat. Ensure that any lap strap is worn low down, so that the pelvis is firmly engaged, the belt is not twisted.

#### 6.4.1 Using the buckle

- Put the two metal sections of the buckle connectors together. (fig.1)
- Slot the two buckle connectors into the slot in the top of the buckle until they "click" into place (fig.2)

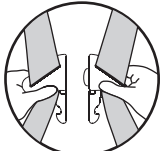

Fig. 1

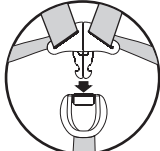

Fig. 2



Fig. 3

- Check the harness is correctly locked by pulling the shoulder straps upwards (fig.3 in pre.page)
- To release the harness, press the red button on the buckle downwards

## 7. Installing the safety group II with backrest

The harness system must be removed from the seat (see point 7.1) when used for these age groups 15kg-36kg. Only the 3-point vehicle belt system can be used to buckle up the child car seat.

### 7.1 Removal of the harness

- Loosening the harness (see point 6.3), Turn the seat to the back.
- Slide both of the harness straps off the harness connector (Fig.1).
- Pull the strap till the steel pole gets out of the slot (Fig.2)
- Now you can remove the belts as well as the tongue in an upwards direction (Fig.3).
- Installation of the harness is carried out in reverse order to removal. Keep harness with all parts in a safe place, to use in future.

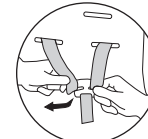

Fig.1

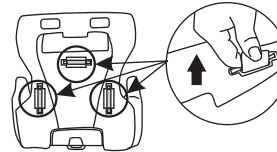

Fig.2

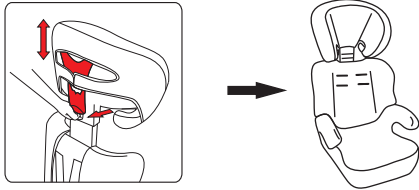

Fig. 3

### 7.2 Height adjustment of headrest

Regularly check whether the headrest is optimally to your child. The height of the headrest is set optimally to the size of your child, when their head rests comfortably in the middle of the headrest.

- In order to set the height, turn the seat to the back. Pull the height adjuster of the headrest. Now the headrest can be pushed upwards or downwards (see the next picture).
- Loosen the height adjuster, the headrest is locked correctly. After adjust. Check that the headrest is locked correctly.



### 7.3 Securing the child car seat with vehicle's belt

The vehicle's 3-point belt system may only be used to buckle up children of the age groups II (15kg-25kg).

The harness system must be removed from the seat (see point 7.1) when used for these age groups 15kg-25kg.

**Step 1:** Place the child safety seat on the vehicle's seat ensuring it is firmly pressed against the car seat backrest (Fig.1)

**Step 2:** Seat your child in the child car seat (Fig.2)



Fig. 1



Fig. 2

**Step 3:** Pull out the 3-point vehicle belt and place the lap belt on the opposite side of the buckle under the arm rest. (make sure that the diagonal belts and the lap belt on the buckle side are under the arm rest) The lap strap should be worn low down, so that the pelvis is firmly engaged and the straps should not be twisted.

**Step 4:** Place the diagonal belt goes through the head belt guide on the side of the headrest. Make sure that the belt is not twisted.

Tighten the adult belts in the direction as picture shows (Fig.3) and the diagonal shoulder belt in the direction of the automatic roll-up as possible (Fig.4).

The satisfactory position of the adult safety-belt buckle relative to the child car seat is as the Fig 5. You can contact the child car seat manufacturer if in doubt about this point.



Fig. 3



Fig. 4



## 8. Installing the seat (group II+III without backrest)

1. Refitting the backrest.

To refit the backrest simply reverse the above process.

2. Fitting your child on the booster seat.

**Step.1** Place the seat forward facing in your car, ensuring it is pushed firmly into the car seat and sit your child on the seat(Fig.2)

**Step .2** Keep the seat-belt tight across you child, holding on to seat-belt at the position where to crosses your child's shoulder(Fig.3)

**Step.3** Now,pull the seat-belt forward away from your child,keeping holding of the seat-belt at the position where it crossed your child's shoulder as this is where the locking clip must be attached to the seat-belt.

**Step.4** Pull the adjuster strap to remove any slack from the locking clip.Your child should now be secure.

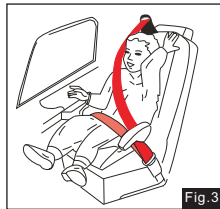
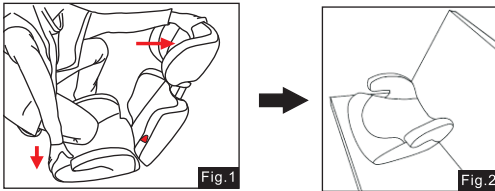

## 9.How to dispose

- Please observe the waste treatment of the country.
- Please put the returnable plastics and mental parts into a corresponding returnable container

## 10.Washing instructions

Use the original seat cover only and the non-original cover will affect its function.

Do not use the child safety seat without seat cover.

● Use only water(under temperature of 30)with neutral detergent to wash the cover.Hang it in the shade after washing and do not wash by machine,spindry or tumbledry is not recommended.

● Wash the plastic parts with warm water and neutral soap.Do not wash with chemicals.

Cover:polyster fibre 100%  
Filling:polyurethene 100%

